

DELTA METALLIC CONST. FACTORY. L.L.C.

Complete Solution for Metal Construction & All Metal Decoration

T : +971-6-5364401

F: +971-6-5368 304

E: sales@deltametallic.com

E: info@deltametallic.com

W: www.deltametallic.com

UAE.Sharjah. Ind. Area No.6.P.O.Box: 23632





PHILOSOPHY

About Us

The essential philosophy of DELTA METALLIC centers around recognizing and understanding the needs of our customers, which inspires our continuous development of innovative products that are unique in form and function and are, as a result, highly recognizable and practical.

Delta Metallic Construction Factory L.L.C (DMCF), one of the leading metallic fabrication and coating companies in the U.A.E, was established in 1993. DMCF caters to the industrial services sector, providing steel projects, steel decoration and steel finishing.

Today, DMCF is considered as one of the most important and strategic companies in the UAE in the field of electro-plating. We are able to offer our customers a wide range of finishes and colors – like gold, silver, brass, copper, and royal antique finish – which are normally imported from countries like Germany and the U.S.

All our products, services, and the projects we undertake are controlled and monitored by a highly qualified and experienced management team, technical staff, fabricators, turners, welders, electro-platters, painters, polishers and support personnel, in order to carry out a wide range of steel works at reasonable and competitive prices.

MISSION

Mission & Vision



Mission

To complement and support the ever-growing projects for Steel and stainless steel architecture and design internationally, with special emphasis on the national needs. To continuously invest in infrastructure and technical expertise and be a leader in the industry creating new standards of quality and service to enhance overall growth. We want our customers and employees to be satisfied.

Vision

To be a benchmark of quality in Metals industry and to make Delta Metallic a brand name synonymous to architectural and industrial metal products globally.

Safety Management

Delta Metallic Construction Factory L.L.C has a comprehensive health and safety management system in place to ensure the well being of all our employees. With regards to occupational health, our corporate policy promotes a work place that protectsthe health of DMCF employees, sub-contractors, and the surrounding community. The policy emphasizes prevention, education, voluntary participation, personal responsibility, and cost effectiveness.

The DMCF health and safety management system relies on the implementation of the DMCF health and safety policies. These are collections of policies and proceduresoutlining various safety topics that include the orientation of new employees, the reporting requirements on site.

Health and wellbeing outside the workplace is also and area that DMCF addresses, as we understand the problems it may result in, related but not limited to absenteeism. As a matter of policy therefore, DMCF provides its personnel with various kinds of assistance, such as informational or medical insurance plans, whilst empowering employees to take charge of their personal health.

Line management is responsible for the implementation of health and safety management system, with the support of the personnel department and the assistance of medical professionals as needed. This health and safety management system takes local conditions into account and complies with the health laws and regulations applicable in the UAE.



Quality Assurance

The commitment towards supporting managerial and business operational systems is essential to realizing the qualitypolicy. We believe in the concept of client and supplier working together seamlessly and enjoyably, as we continually strive for improvements in quality of our service. The quality policy is based on 3 fundamental principles. Ensuring that we fully identify and conform to the needs of our customers. Looking at our service provision processes, identifying the potential for errors, and taking the necessary action to eliminate them.

Everyone understanding how to do their job and doing it right the first time round.To ensure that the policy is successfully implemented, staff will be responsible for identifying customer requirements, and ensuring that the correct procedures are followed to meet those requirements.

Objectives needed to ensure that the requirements of this policy are met and that continual improvements are maintained in line with the spirit of the policy, will be set, determined and monitored at Management Review.

The quality policy principles and objectives will be communicated and available to staff at all times. Training will be an integral part of the strategy to achieve the objectives.Within this Policy we are committed to operating our Company under the disciplines planned and developed jointly with our other management functions.

We are all committed to operating continuously to this standard and we will maintain the necessary Quality Approvals consistent with our customer requirements.Our Company will constantly review and improve on our services to ensure tasks are completed in the most cost-effective and timely manner for the benefit of all our customers. We shall ensure that all our personnel understand and fully implement our corporate policies and objectives and are able to perform their duties effectively through an ongoing training and development program.



YOUR NEXT LEVEL OF METALLIC FINISH



INDEX

Custom Made Products	10-19
Stainless Steel Cladding	20-27
Laser Cutting	28-31
Metal Decoration	32-35
Gates & Fences	36-41
Metal Plating	42-45
Custom Metal Air Grill	46-51
Custom Stainless Steel Grating	52-57
Steel Bollards	58-61
Bicycle Racks	62-65
Stainless Steel & Metal Cat Ladder	66-69
Steel Structure	70-73
Handrail	74-105
Metal Glass Staircase	106-121
Signage General	122-129
Projects	130-135
Certificates	136-143

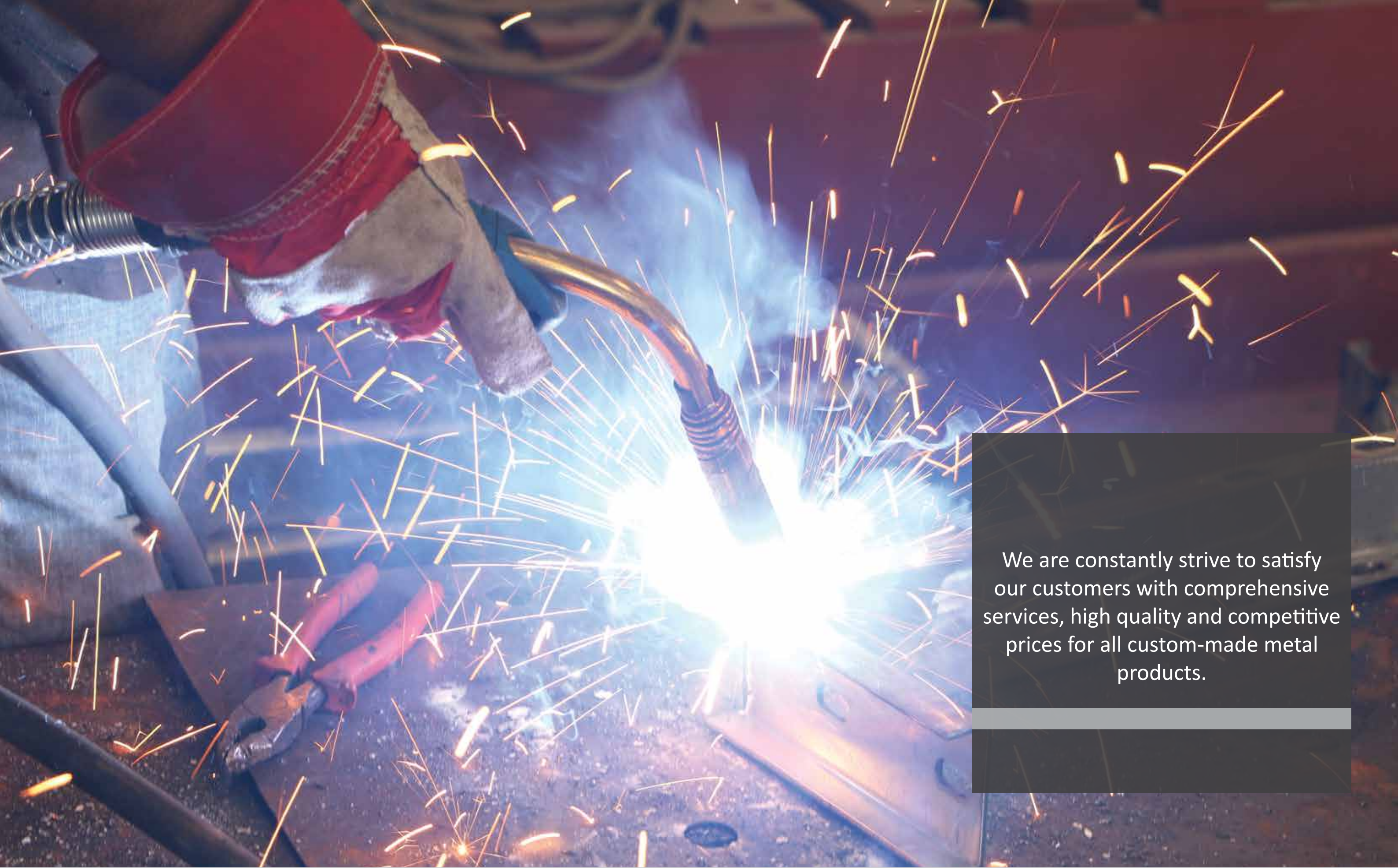

We are constantly strive to satisfy our customers with comprehensive services, high quality and competitive prices for all custom-made metal products.

Custom Made Products

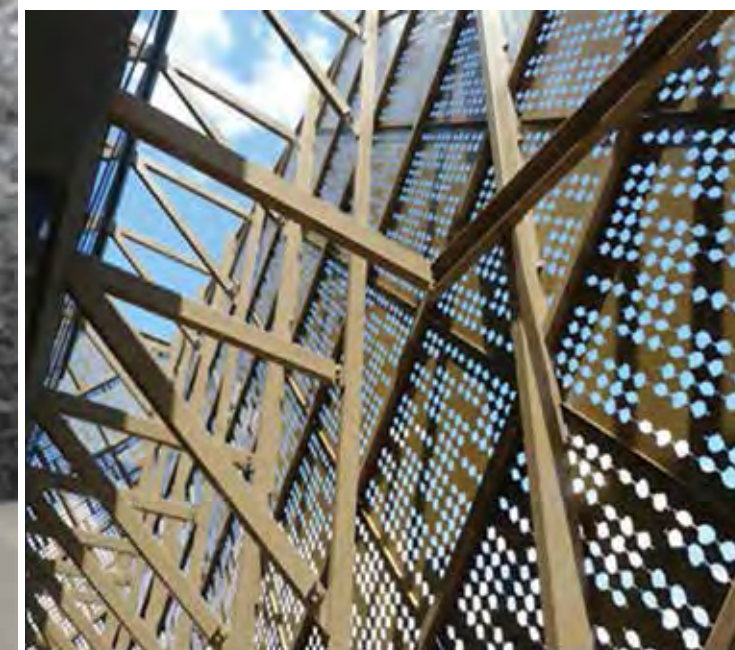



STAINLESS STEEL CANOPY



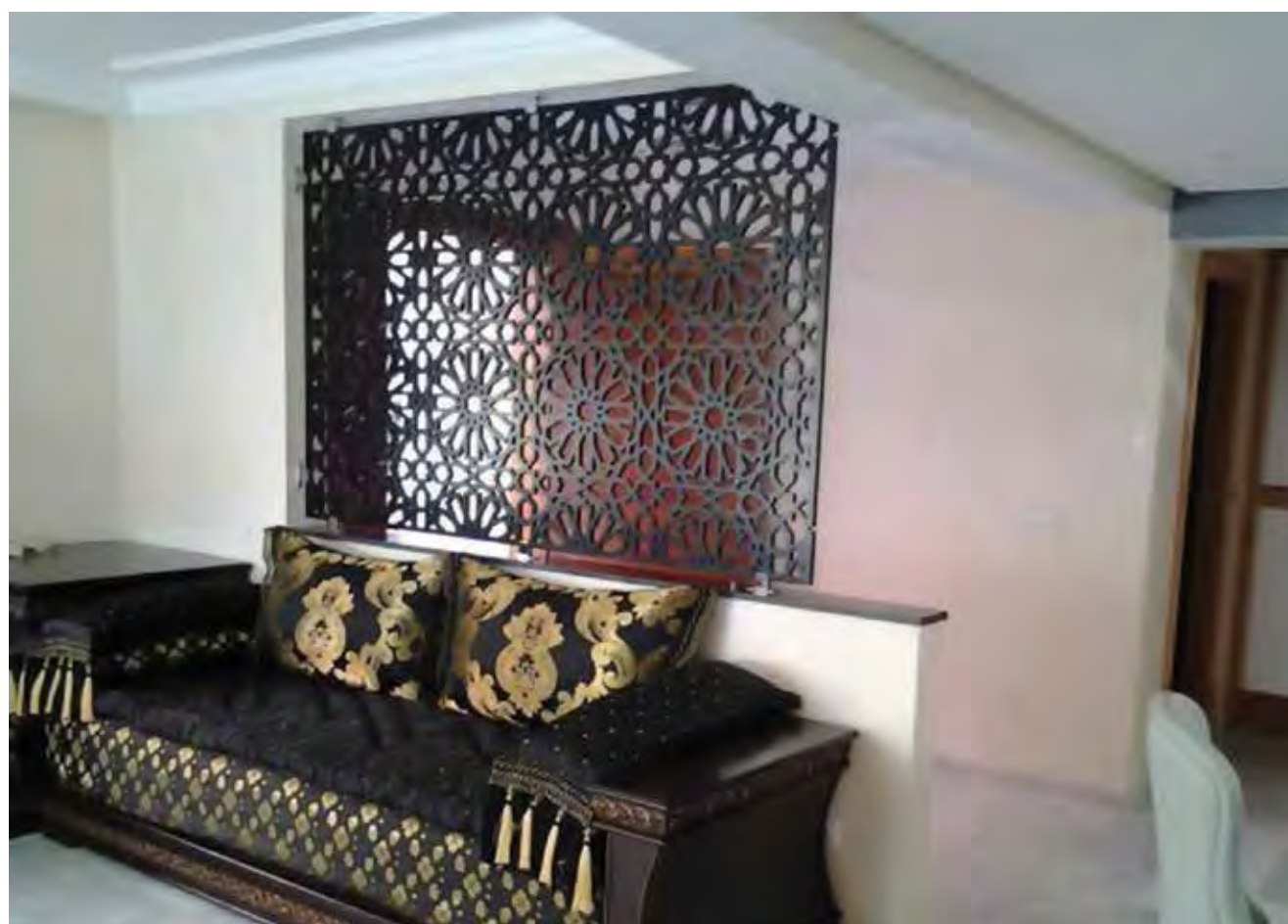

SS304, SS3016 : BRUSH & MIRROR FINISH

DIVIDING STRIP





Metal Cladding



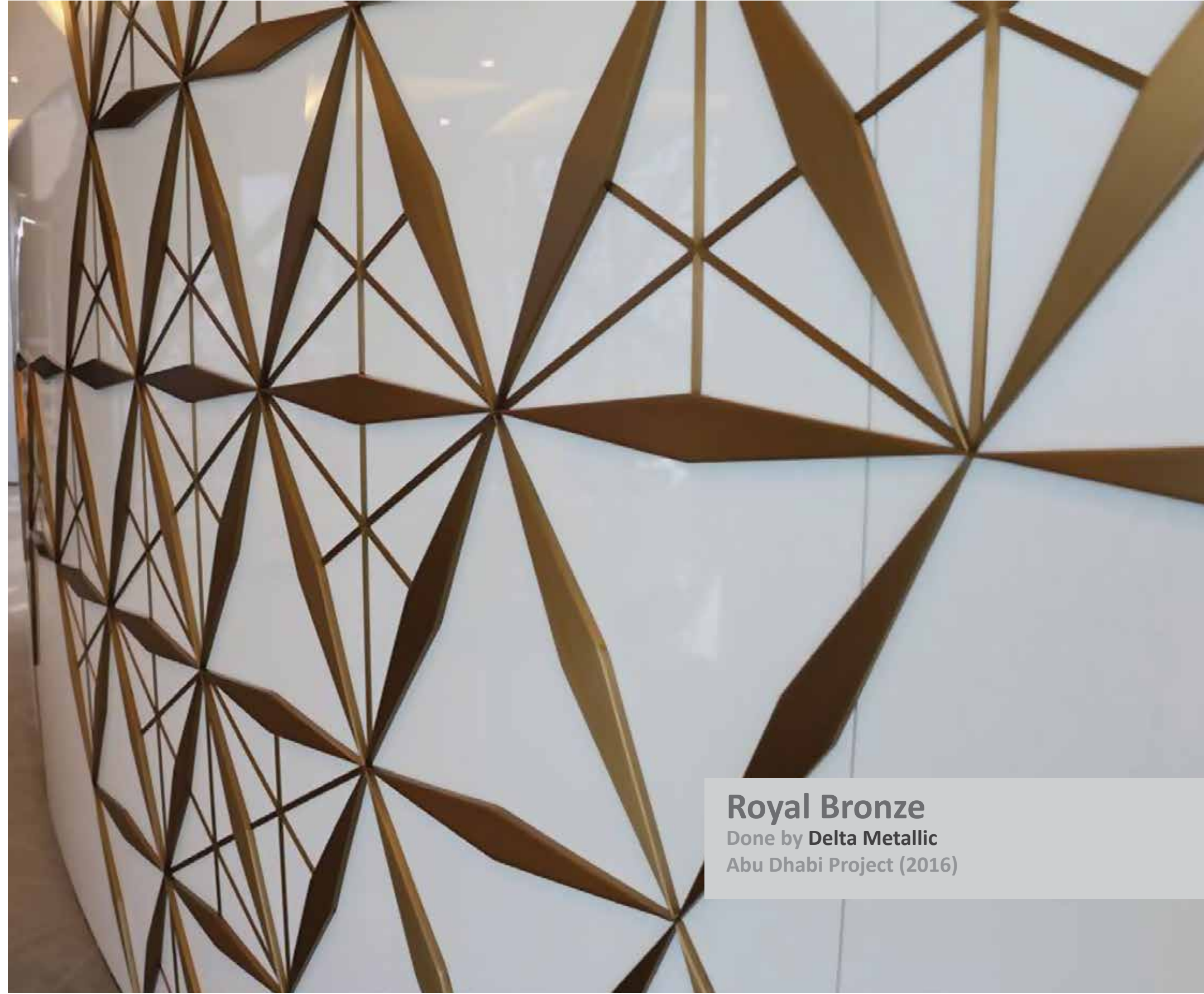

Royal Bronze
Done by Delta Metallic
Abu Dhabi Project (2016)



Dubai Airport
Terminal 1/ Duty Free
Project (2017)

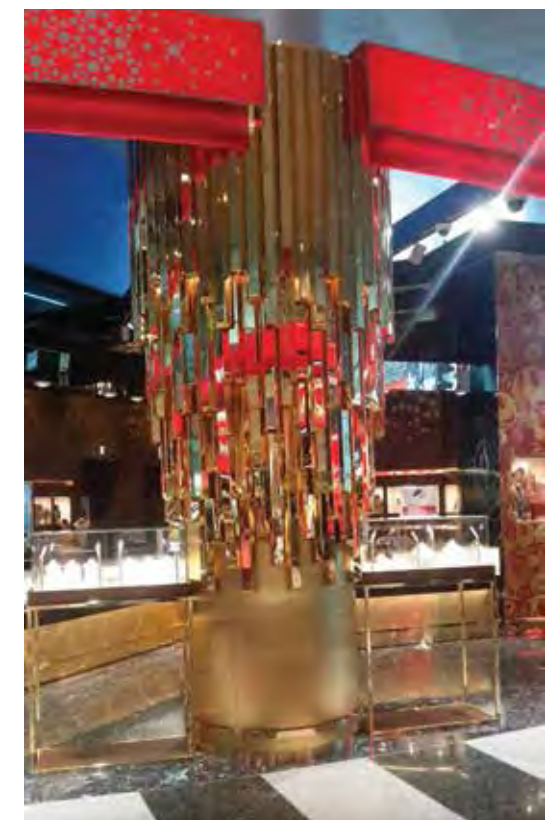

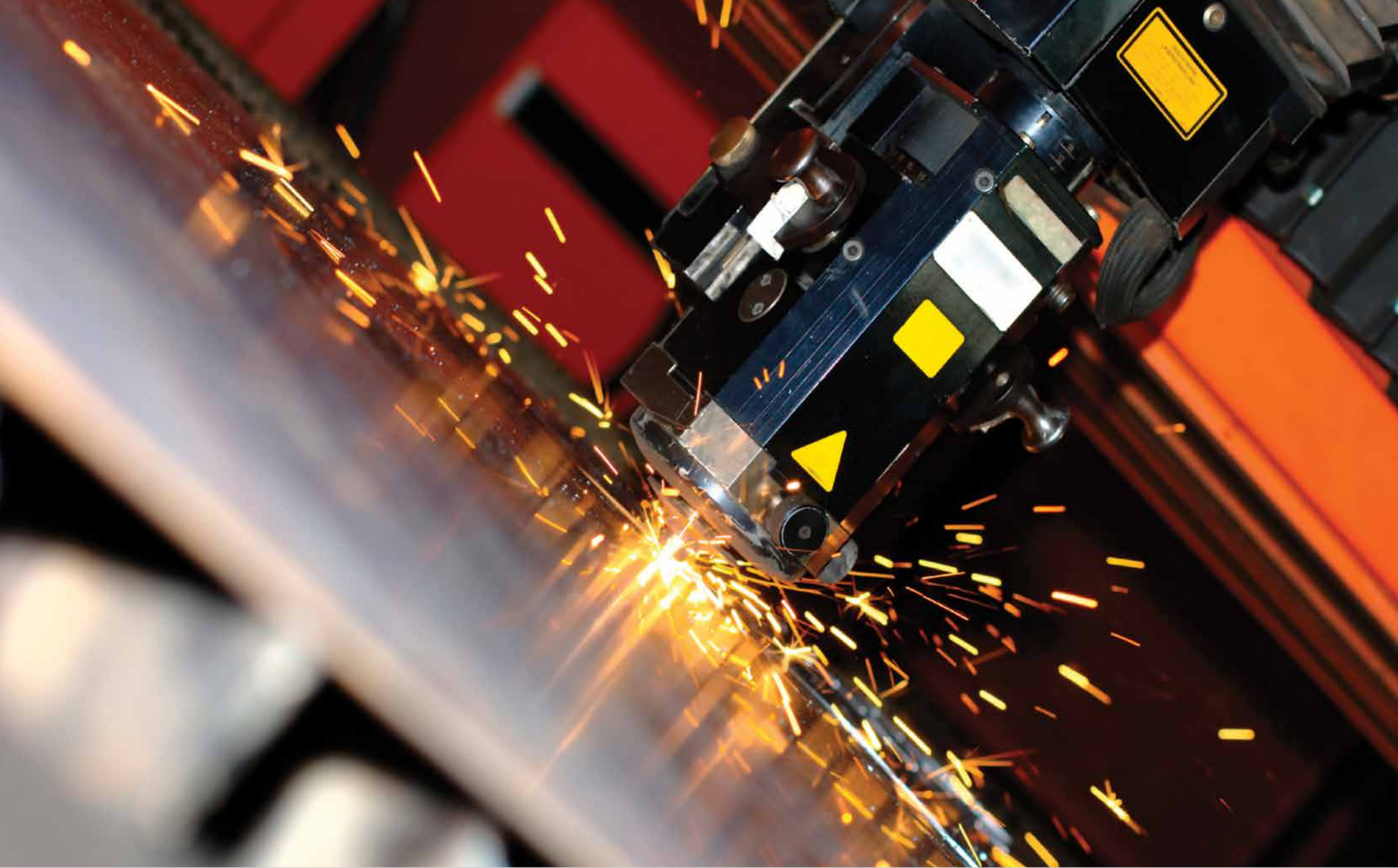

Laser Cutting





Metal Decoration



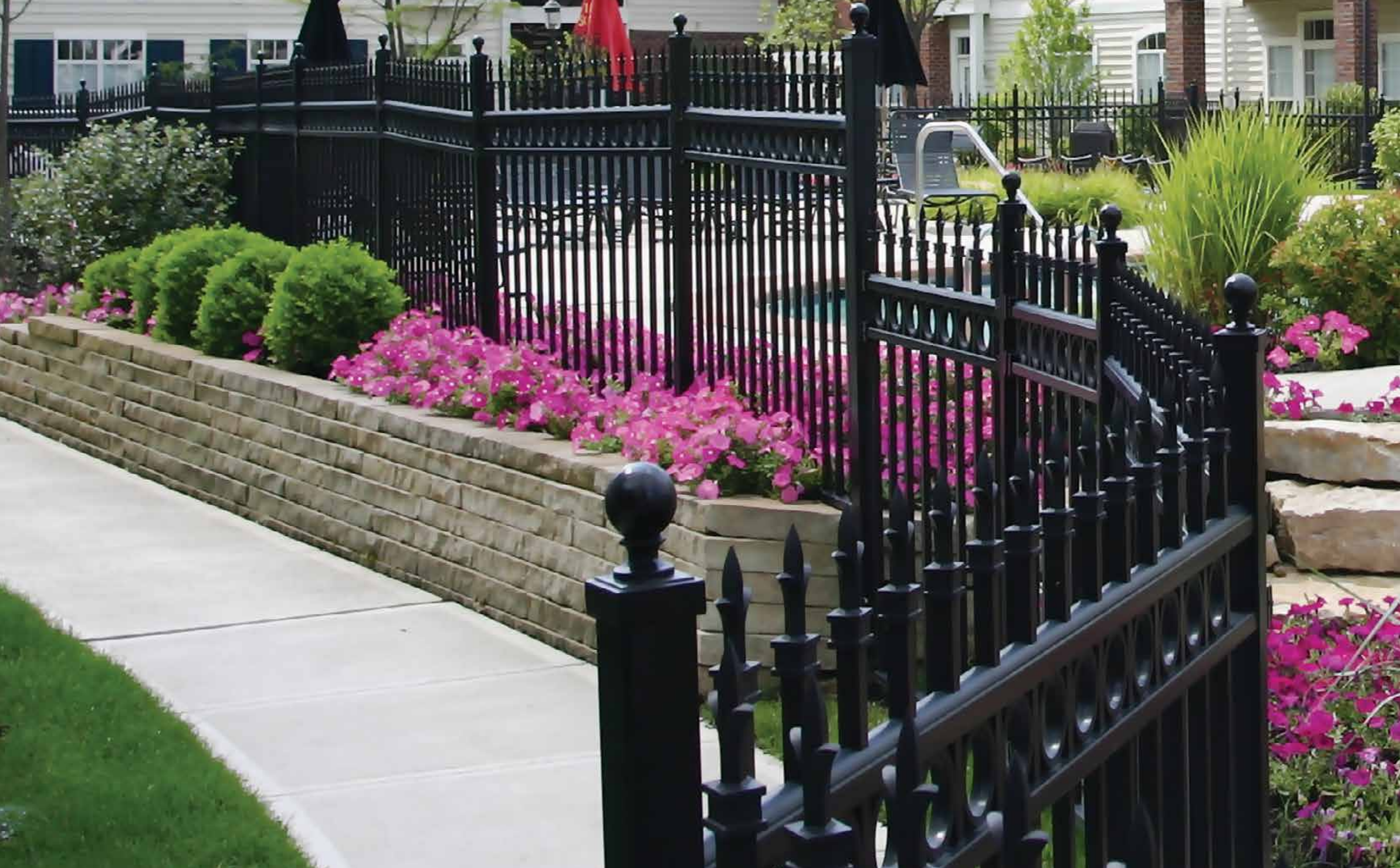

Gates & Fences







Metal Plating & Finishing



Custom Metal A/C Grill

METAL DECORATION
CUSTOM A/C GRILL



STAINLESS STEEL
A/C GRILL



STRUCTURE
A/C GRILL (FOR JAILS)

STAINLESS STEEL

LISEAR GRILL



METAL DECORATIVE

A/C GRILL





Custom Stainless Steel Grating



Electric-polished,
Stain polished,
Acid clean passivation finish is standard.

All Channels and Grates are
304/3016 Stainless Steel

Bathroom and swimming pool
project solution

WEDGE WIRE GRATES

Century woven developed an outstanding manufacturing process for wedge wire profile, which provides customers with creative and functional solution for their projects.

- 100% flat surface
- Touching without crimped
- Kinds of surface treatment
 - . Electric- polished
 - . Stain polished (Brushed)
 - . Acid clean passivation
 - . Mirror polished
 - . Drawing the oil mill (NO. 4 finish)



Steel Bollards





Bicycle Racks





**Stainless Steel &
Metal Cat Ladder**





Steel Structure





Handrail

Stainless Steel

Baluster Posts

Delta Metallic presents a full range of uprights for stairs and railings, balusters with glass, ropes or fills in circles or full pipe.

They are prepared for the attack to the floor or to the side connection.

They can also be suitable according to your requests, drilled and tapped or even already fitted with all the accessories for installation.

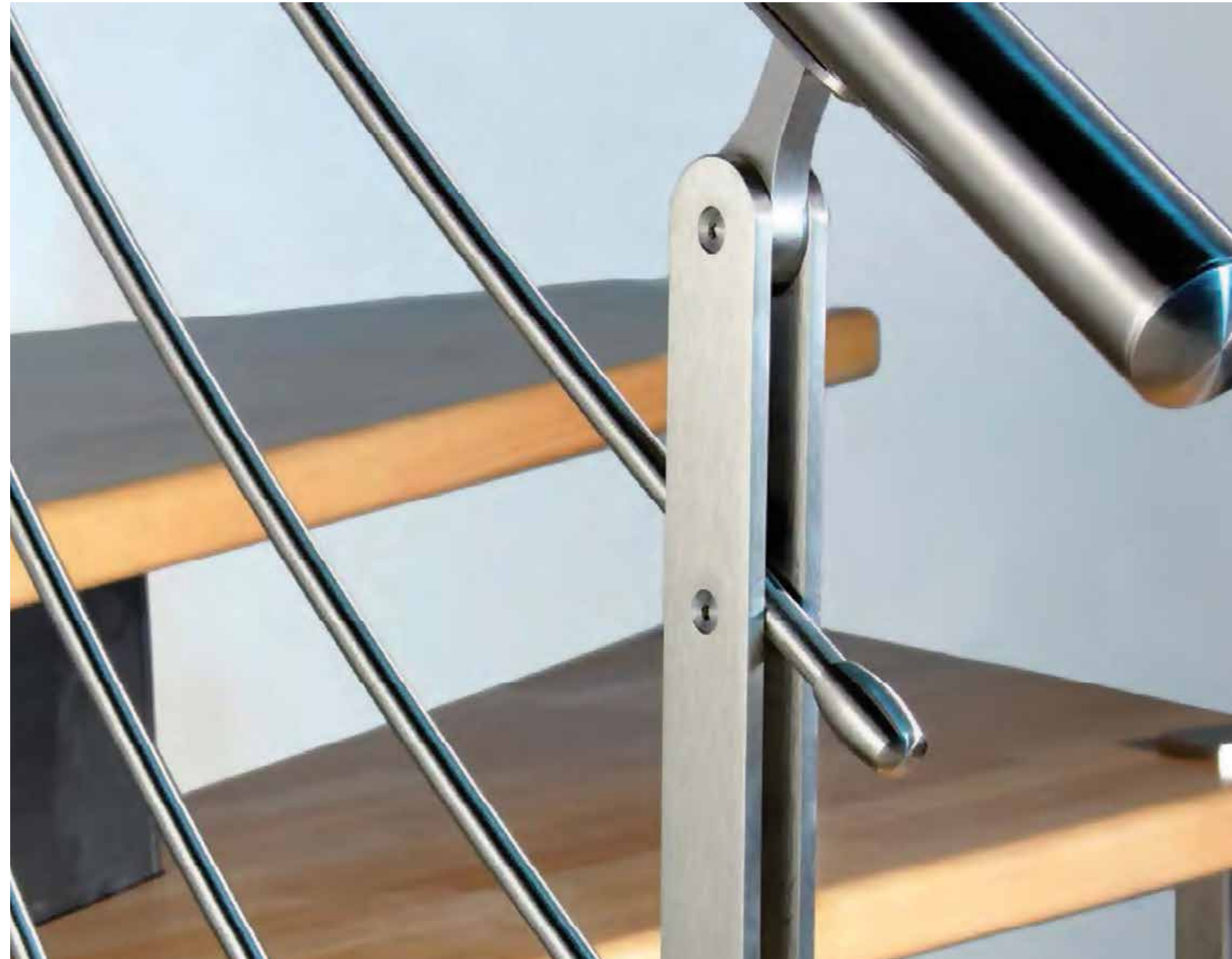



Bending

Our CNC sheet metal bending center allows any sheet-turn machining us precise and perform on time. Through our well-equipped tool storage we are able to respond quickly and flexibly to different customer requirements.

We turn to you with sheet metal parts up to 3000mm in length and up to 10mm thickness.

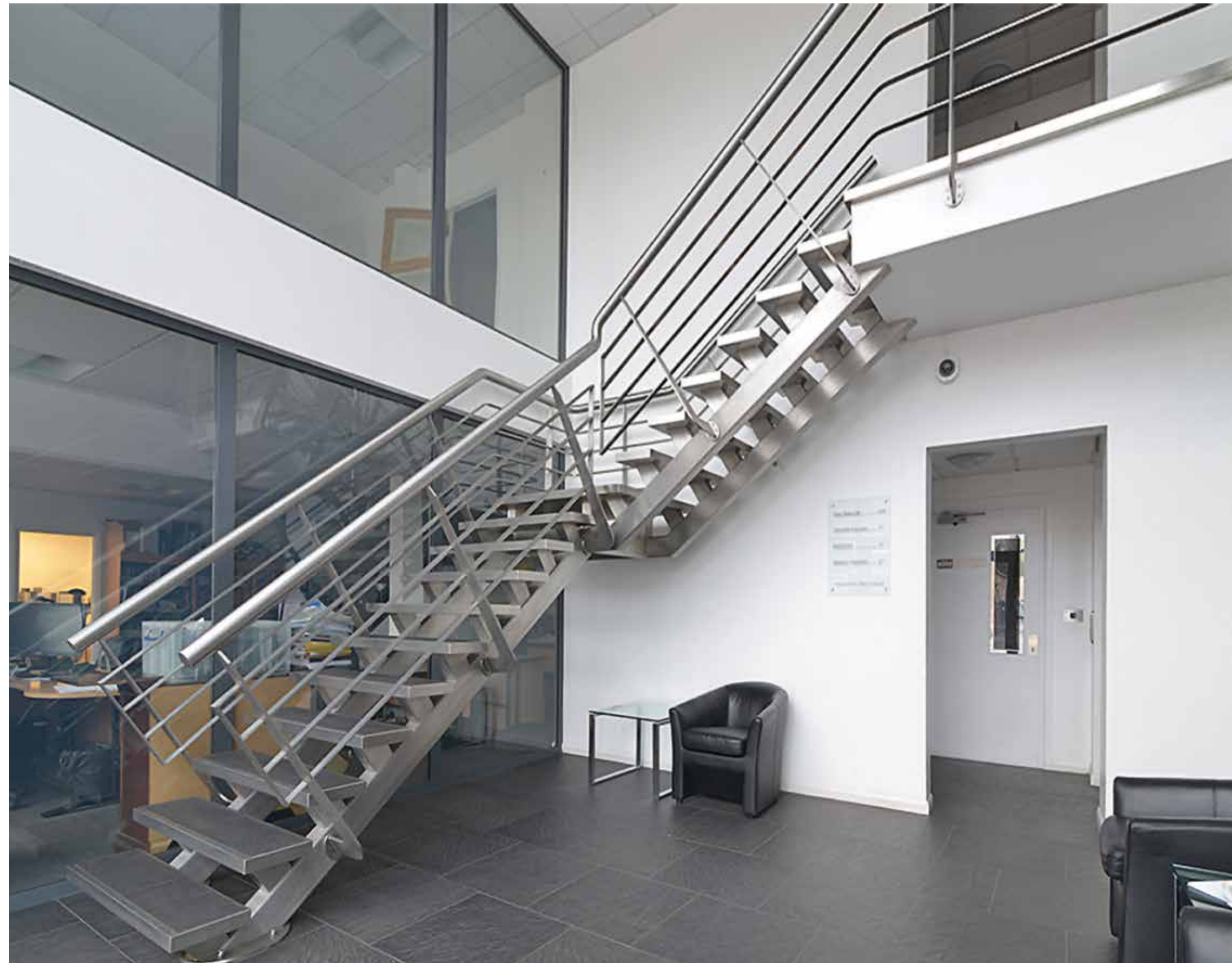

Polished Surfaces

For our standard products in stainless steel A2 (AISI 304) and A4 (AISI 316),

we provide a grain grinding Finish. At the customer or due to special outer-union events such as Swimming Pool Equipments or in the sea, we also manufacture these products in stainless steel A4 (AISI 316)





Bending Service

With our expertise in technology and design, we realize your Dron, ring and spiral work and assist you in the preparation of projects. The combination of modern machinery and individual attention and competent skilled workers will allow you to give your Wanting designs and ideas an aesthetic form.



Technical Support

Is it special requirements of functional or architectural nature which. By custom or can also be implemented with our standard products, our engineers will be happy to plan your project aside Send us your inquiry and we will find the right solution, at all times to guarantee the optimal design that meets your aesthetic and technical requirements. For assembly operations, our technically trained staff by phone, in the form of an assistant insert to complete installation of your desired project available. All installation work is carried out on schedule and in compliance with all safety regulations.





Simply Glass

The new system simply glass impresses with its straightforwardness and transparency. Thanks to the asymmetric and the resulting, remarkably lightweight design of the profile, good static load values with reduced system weight are extremely feasible.

Due to the reduced weight and associated material savings is simply-glass, despite higher static power, fully priced competition-capable. Practical and quick installation also reduces the use of labor power on the spot and is a guarantee for a flawless result.

Tubes Brushed or Polished

Code	Inches	Size
D20724		Ø12x1,5x3000
D20725		Ø12x1,5x6000
D20726		Ø14x1,5x3000
D20727		Ø14x1,5x6000
D20728		Ø16x1,5x3000
D20729		Ø16x1,5x6000
D20732		Ø20x2,0x3000
D20733		Ø20x2,0x6000
D20734	1 1/2"	Ø21,3x2,0x3000
D20735	1 1/2"	Ø21,3x2,0x6000
D20736		Ø25x2,0x3000
D20737		Ø25x2,0x6000
D20738	3/4"	Ø26,9x2,0x3000
D20739	3/4"	Ø26,9x2,0x6000
D20760		Ø30x2,0x3000
D20761		Ø30x2,0x6000
D20770	1"	Ø33,7x2,0x3000
D20771	1"	Ø33,7x2,0x6000
D20775	1"	Ø33,7x2,6x3000
D20776	1"	Ø33,7x2,6x6000
D20748		Ø40x2,0x3000
D20749		Ø40x2,0x6000
D20750	1 1/4"	Ø42,4x2,0x3000
D20751	1 1/4"	Ø42,4x2,0x6000
D20751-HF	1 1/4"	Ø42,4x2,0x6000
D20755	1 1/4"	Ø42,4x2,6x3000
D20756	1 1/4"	Ø42,4x2,6x6000
D20757	1 1/2"	Ø48,3x2,0x3000
D20758	1 1/2"	Ø48,3x2,0x6000
D20745	1 1/2"	Ø48,3x2,6x3000
D20746	1 1/2"	Ø48,3x2,6x6000
D20778	2"	Ø60,3x2,5x3000
D20779	2"	Ø60,3x2,5x6000
D20780	2"	Ø60,3x2,0x3000
D20781	2"	Ø60,3x2,0x6000

Round Material Brushed or Polished



Code	Size
D20648	Ø8x3000
D20649	Ø8x6000
D20650	Ø10x3000
D20651	Ø10x6000
D20652	Ø12x3000
D20653	Ø12x6000
D20654	Ø14x3000
D20655	Ø14x6000
D20656	Ø16x3000

Square Tubes Brushed or Polished



Code	Size
D20672	12x12x1,5x6000
D20674	20x20x2,0x6000
D20676	25x25x2,0x6000
D20678	30x30x2,0x6000
D20680	40x40x2,0x6000
D20681	50x50x2,0x6000
D20682	60x60x2,0x6000

Square Tubes Brushed or Polished

Code	Size
D20690	30x20x2,0x6000
D20691	40x20x2,0x6000
D20692	40x30x2,0x6000
D20693	50x30x2,0x6000
D20694	60x40x2,0x6000

Flat Material Brushed



Code	Size
D20621	20x3x4000
D20622	20x5x4000
D20623	20x8x4000
D20619	25x4x4000
D20620	25x8x4000
D20625	30x5x4000
D20624	30x8x4000
D20626	30x10x4000
D20608	40x5x4000
D20609	40x6x4000
D20610	40x8x4000
D20612	40x10x4000
D20611	50x5x4000
D20613	50x8x4000
D20614	50x10x4000
D20615	60x5x4000
D20617	60x8x4000
D20616	60x10x4000

Tubes Polished



Code	Size
D20724-P	Ø12x1,5x3000
D20725-P	Ø12x1,5x6000
D20750-P	Ø42,4x2,0x3000
D20751-P	Ø42,4x2,0x6000

Highly Polished not Coated

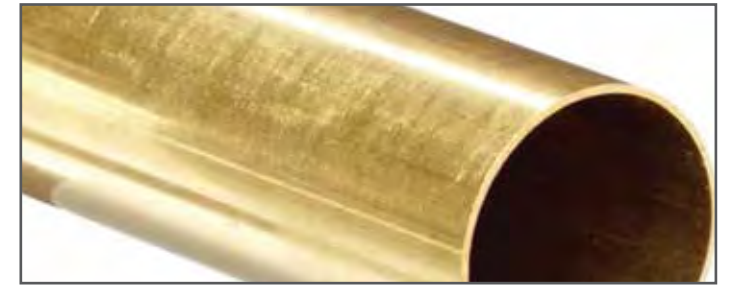

Code	Size
D20700	Ø42,1x2x3000

Tubes Drilled on One Side Brushed



Code	INCHES	Size	Ø
D20790	1"	Ø33,7x2,0x3000	12
D20792	1 1/4"	Ø42,4x2,0x3000	12

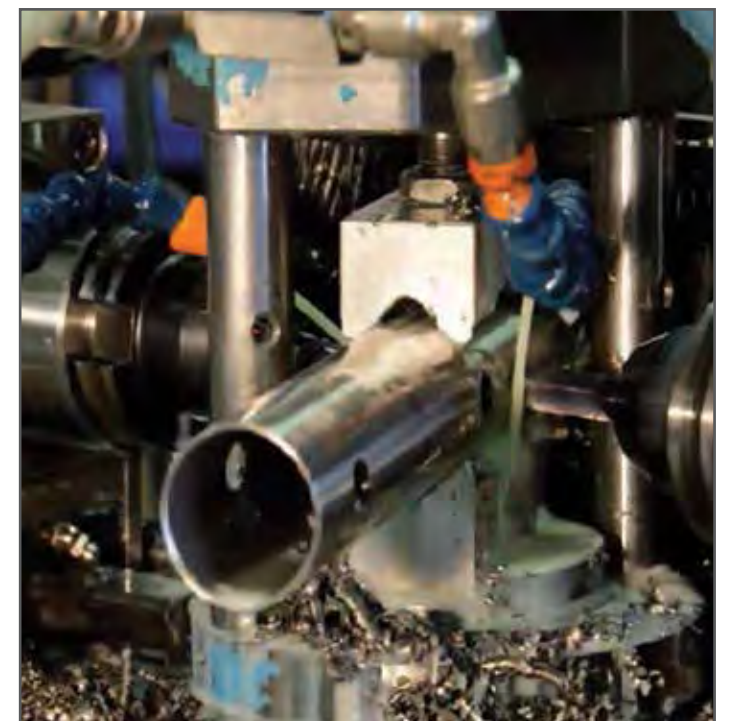



Handrail Curves

30°

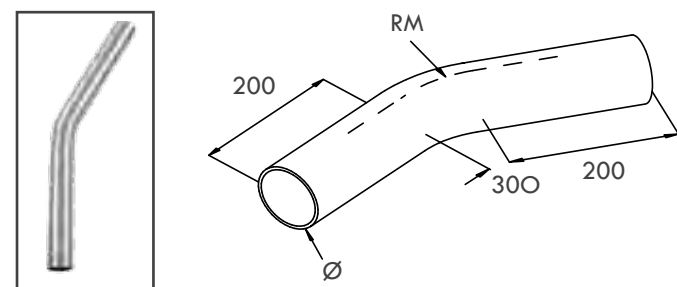

45°

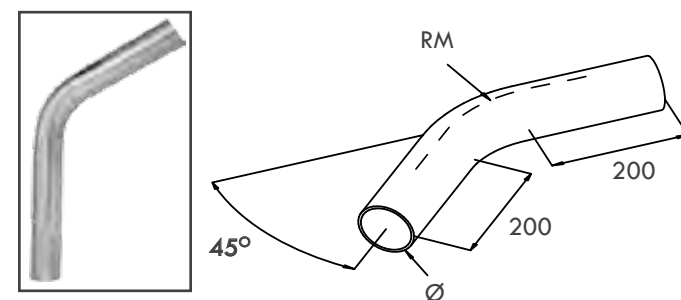

Code	INCHES	Ø	RM
D60030	3/4"	26,9x2	54 mm
D60130	1"	33,7x2,6	68 mm
D60230	1 1/4"	42,4x2	88 mm
D60330	1 1/4"	42,4x2,6	88 mm
D60430	1 1/2"	48,3x2,6	85 mm

Code	INCHES	Ø	RM
D60045	3/4"	26,9x2	54 mm
D60145	1"	33,7x2,6	68 mm
D60245	1 1/4"	42,4x2	88 mm
D60345	1 1/4"	42,4x2,6	88 mm
D60445	1 1/2"	48,3x2,6	85 mm

60°

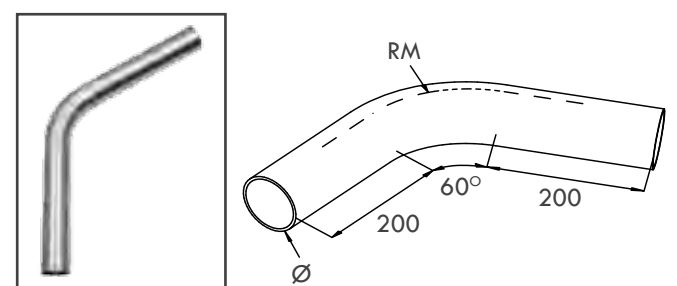

90°

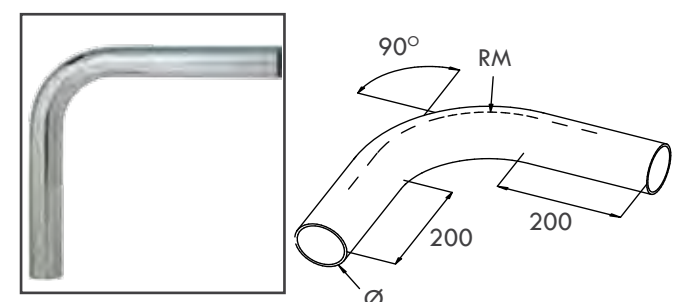

Code	INCHES	Ø	RM
D60060	3/4"	26,9x2	54 mm
D60160	1"	33,7x2,6	68 mm
D60260	1 1/4"	42,4x2	88 mm
D60360	1 1/4"	42,4x2,6	88 mm
D60460	1 1/2"	48,3x2,6	85 mm

Code	INCHES	Ø	RM
D60090	3/4"	26,9x2	54 mm
D60190	1"	33,7x2,6	68 mm
D60290	1 1/4"	42,4x2	88 mm
D60390	1 1/4"	42,4x2,6	88 mm
D60490	1 1/2"	48,3x2,6	85 mm



120°

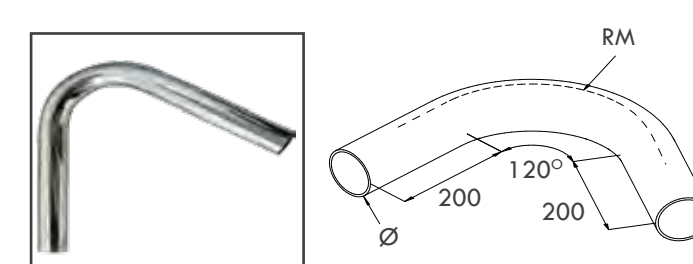

Code	INCHES	Ø	RM
D60012	3/4"	26,9x2	54 mm
D60112	1"	33,7x2,6	68 mm
D60212	1 1/4"	42,4x2	88 mm
D60312	1 1/4"	42,4x2,6	88 mm
D60412	1 1/2"	48,3x2,6	85 mm

180°

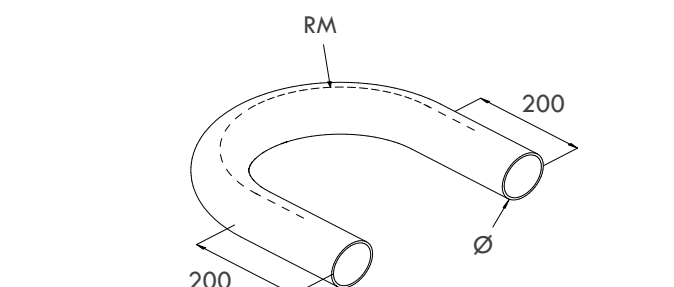

Code	INCHES	Ø	RM
D60018	3/4"	26,9x2	54 mm
D60118	1"	33,7x2,6	68 mm
D60218	1 1/4"	42,4x2	88 mm
D60318	1 1/4"	42,4x2,6	88 mm
D60418	1 1/2"	48,3x2,6	85 mm

180°

Adjustable Elbows 180°

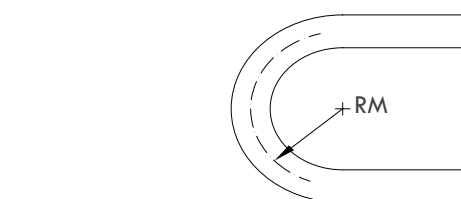

Code	INCHES	Ø	RM
D60308	1 1/4"	42,4x2,6	74 mm
D60318	1 1/4"	42,4x2,6	90 mm
D60328	1 1/4"	42,4x2,6	100 mm
D60338	1 1/4"	42,4x2,6	110 mm
D60348	1 1/4"	42,4x2,6	120 mm
D60368	1 1/4"	42,4x2,6	150 mm
D60378	1 1/4"	42,4x2,6	200 mm

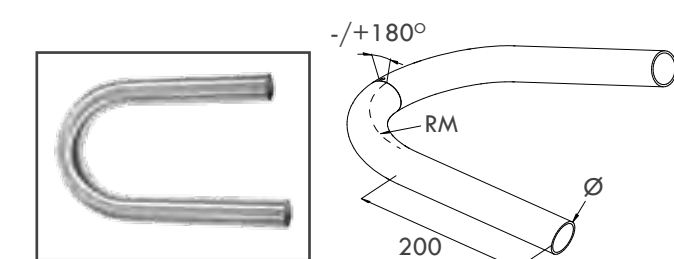

Code	INCHES	Ø	RM
D60319	1 1/4"	42,4x2,6	90 mm
D60329	1 1/4"	42,4x2,6	100 mm
D60339	1 1/4"	42,4x2,6	110 mm
D60349	1 1/4"	42,4x2,6	120 mm

Curves 90° for Welding

Code	INCHES	Ø	H
D60010	3/4"	26,9x2	30
D60020		30x2	44
D60110	1"	33,7x2	38
D60120		40x2	61
D60210	1 1/4"	42,4x2	48
D60410	1 1/2"	48,3x2	57
D60510	2"	60,3x2	76

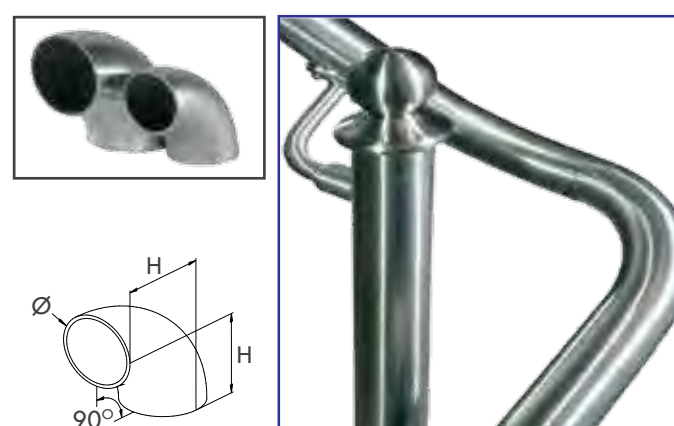



Handrail

Starting Parts - Tube Connector - Fittings - Tube Plugs - Fittings for Square Tubes

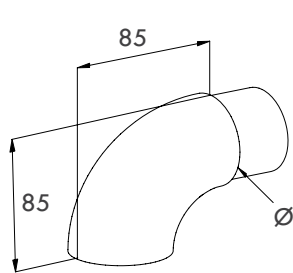
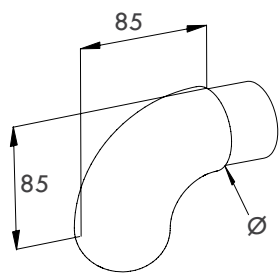

Code	Ø
D60202	42,4x2

Code	Ø
D60203	42,4x2

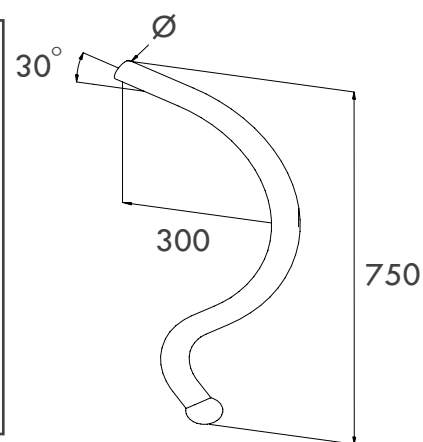
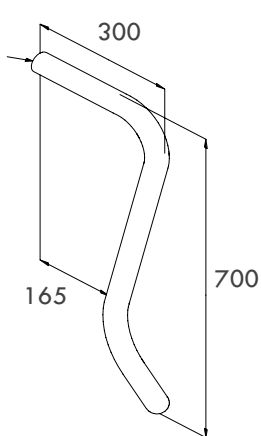
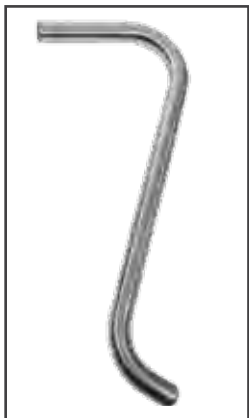

Code	Ø
D60104	33,7x2,6
D60204	42,4x2,6

Code	Ø
D60101	33,7x2,6
D60201	42,4x2,6

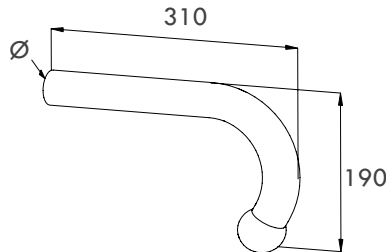

Code	Ø
D60100	33,7x2,6
D60200	42,4x2
D60300	42,4x2,6

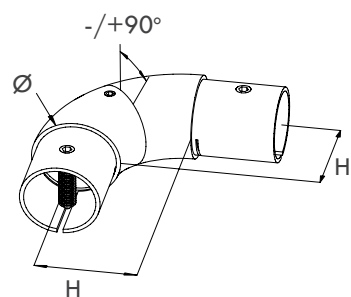

Code	Ø	H
D62102	33,7x2	43
D62105	42,4x2	43
D62106	42,4x2,6	43
D62107	48,3x2	43



Ajustable 90°-180°

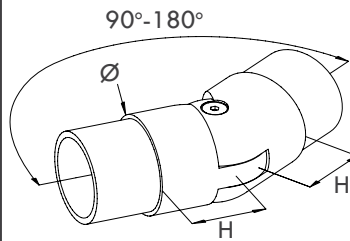

Code	Ø	H
D62122	33,7x2	24
D62125	42,4x2	27
D62127	48,3x2	35

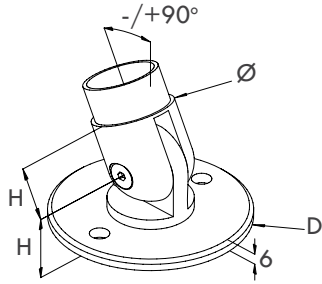

Code	Ø	H	H1	D
D62318	33,7x2	23	27	80
D62320	42,4x2	27	33	100
D62319	48,3x2	30	35	100

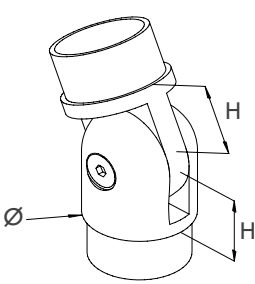

Code	Ø	H
D62312	33,7x2	22
D62316	42,4x2	27
D62317	48,3x2	30

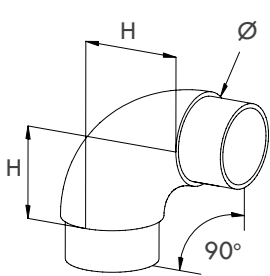

Code	Ø	H
D62302	33,7x2	35
D62306	42,4x2	43
D62307	48,3x2	50

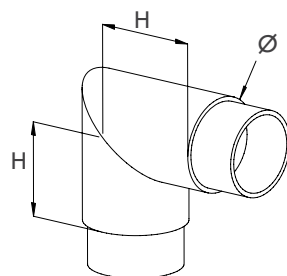

Code	Ø	H
D62322	33,7x2	25
D62326	42,4x2	30
D62327	48,3x2	35

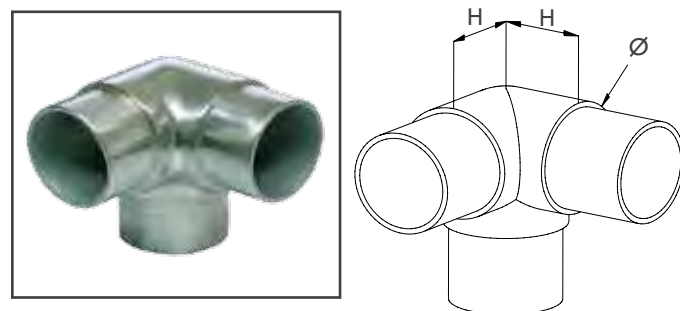

Code	Ø	H
D62332	33,7x2	25
D62336	42,4x2	30
D62337	48,3x2	35

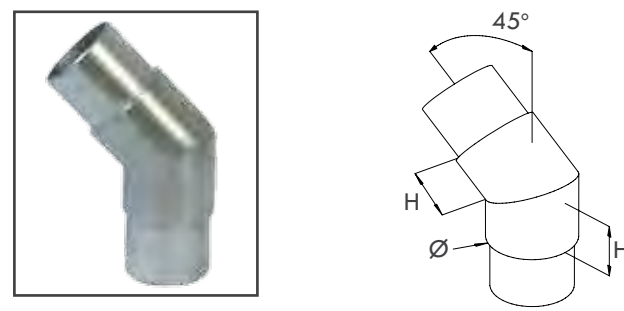

Code	Ø	H
D62342	33,7x2	25
D62345	42,4x2	30
D62347	48,3x2	35

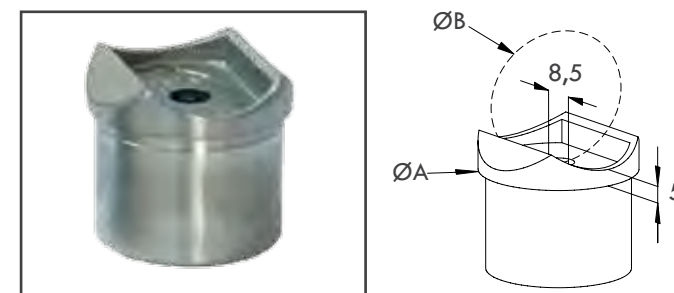

Code	ØA	ØB
D62601	33,7x2	33,7x2
D62605	42,4x2	42,4x2
D62606	42,4x2,6	42,4x2,6
D62603	33,7x2	42,4x2
D62604	42,4x2	48,3x2
D62607	42,4x2,6	48,3x2



Code	ØA	ØB
D62631	33,7x2	33,7x2
D62632	33,7x2,6	33,7x2,6
D62635	42,4x2	42,4x2
D62636	42,4x2,6	42,4x2,6
D62633	33,7x2	42,4x2
D62634	33,7x2,6	42,4x2

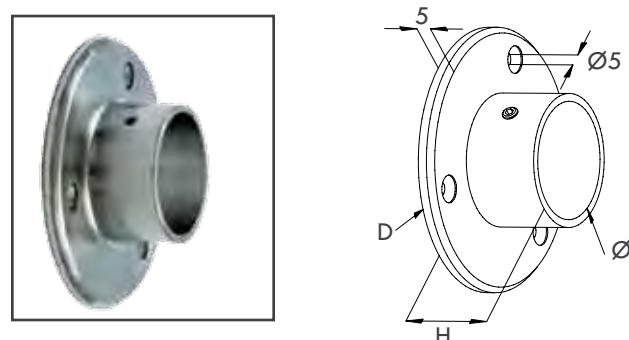

Code	Ø	H	D
D62352	33,7	30	Ø85
D62356	42,4	30	Ø95
D62357	48,3	35	Ø100

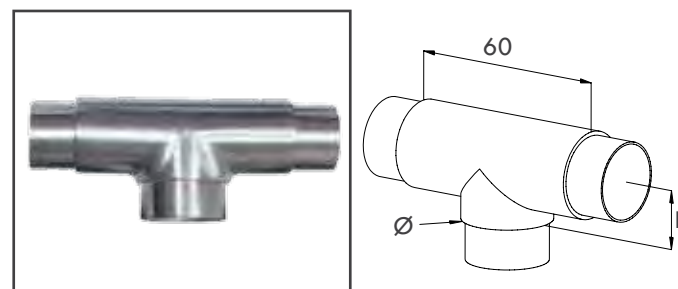

Code	Ø	H
D62386	42,4x2	30

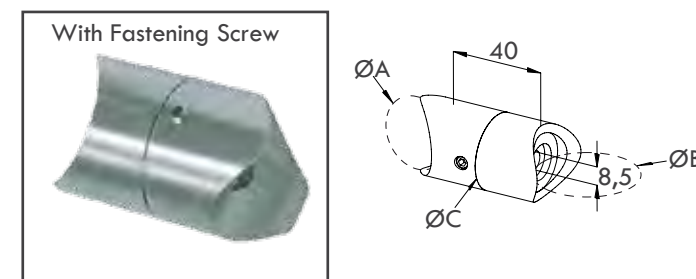

Code	ØA	ØB
D62622	33,7	33,7
D62623	33,7	42,4
D62626	42,4	42,4
D62627	42,4	48,3
D62628	48,3	48,3

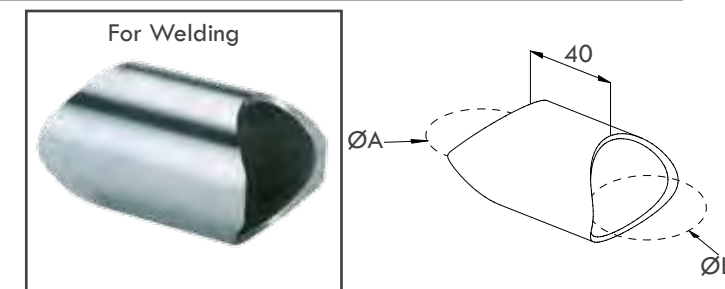

Code	ØA	ØB
D62642	33,7	33,7
D62643	33,7	42,4
D62646	42,4	42,4
D62647	42,4	48,3
D62648	48,3	48,3

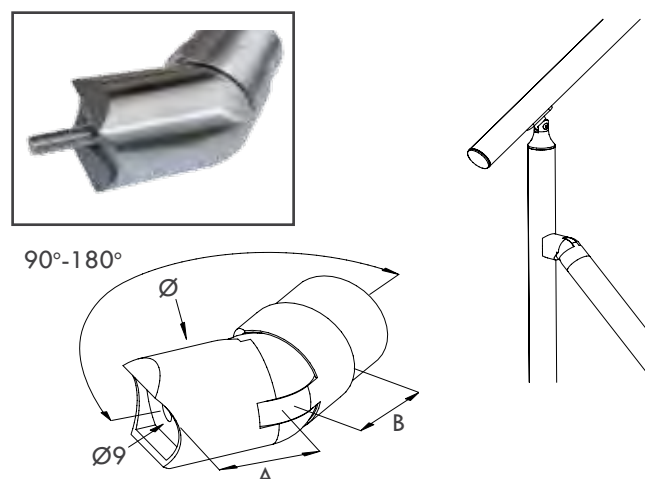

Code	Ø	A	B
D62395	42,4x2	35	27

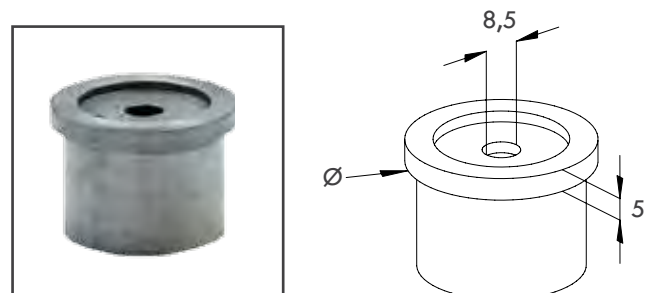

Code	Ø
D62611	33,7x2
D62615	42,4x2
D62616	42,4x2,6
D62617	48,3x2
D62618	48,3x2,6

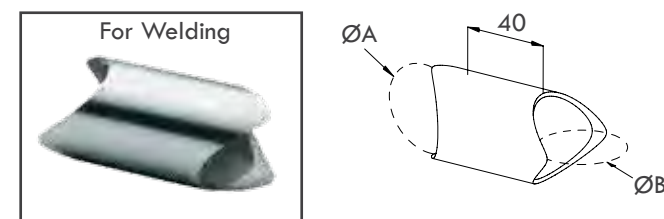

Code	ØA	ØB
D62652	33,7	33,7
D62653	33,7	42,4
D62656	42,4	42,4

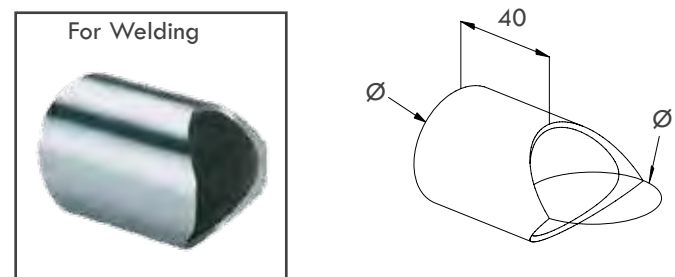

Code	Ø
D62662	33,7
D62666	42,4

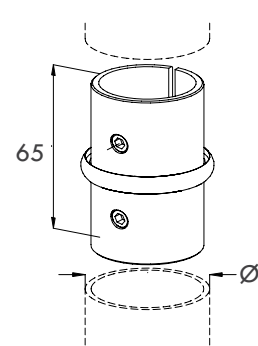
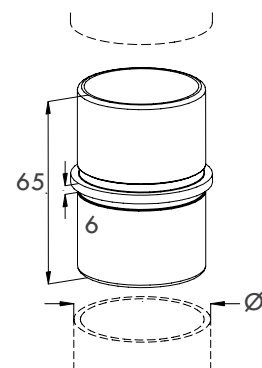

Code	Ø
D62051	33,7x2
D62055	42,4x2
D62057	48,3x2

Code	Ø
D62041	33,7x2
D62045	42,4x2
D62047	D62047 48,3x2

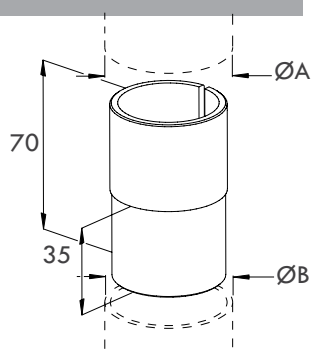
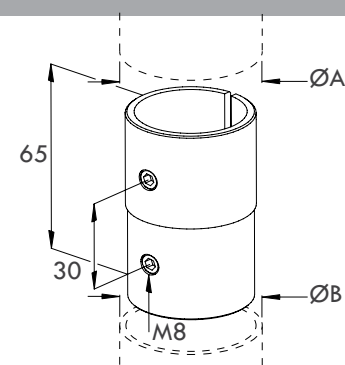

Code	ØA	ØB
D62002	33,7x2	33,7x2,6
D62006	42,4x2	42,4x2,6
D62008	48,3x2	48,3x2,6

Code	ØA	ØB
D62020	33,7x2	33,7x2,6
D62026	42,4x2	42,4x2,6
D62028	48,3x2	48,3x2,6

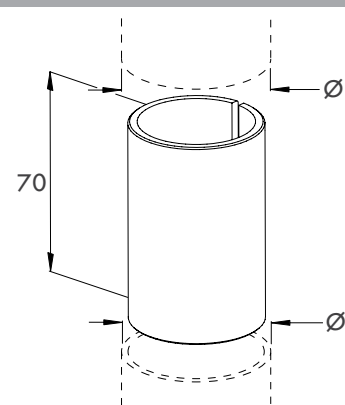
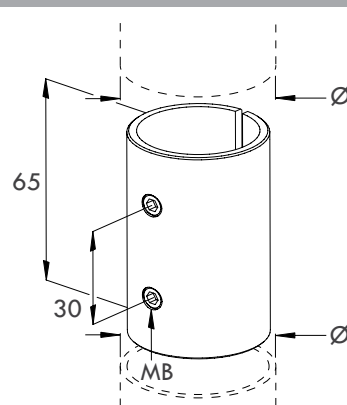

Code	Ø
D62011	33,7x2
D62012	33,7x2,6
D62015	42,4x2
D62016	42,4x2,6
D62017	48,3x2
D62018	48,3x2,6

Code	Ø
D62031	33,7x2
D62032	33,7x2,6
D62035	42,4x2
D62036	42,4x2,6
D62037	48,3x2
D62038	48,3x2,6

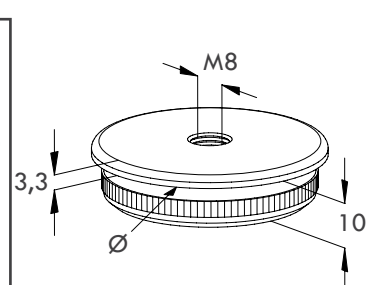
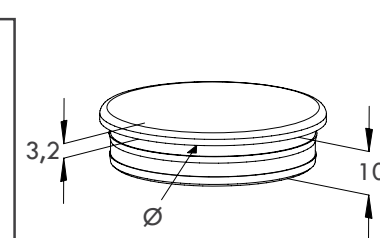

Code	Ø
D61202	12x1,5
D61203	14x1,5
D1208	20x2
D61210	26,9x2
D61211	33,7x2
D61215	42,4x2
D61217	48,3x2
D61219	60,3x2,5

Code	Ø
D61220	26,9x2
D61221	33,7x2
D61225	42,4x2
D61227	48,3x2
D61229	60,3x2,5

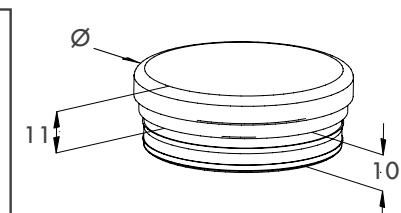
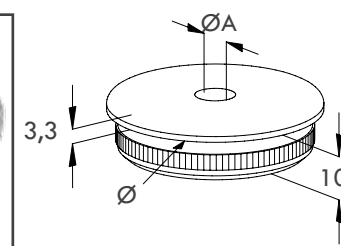

Code	Ø	ØA
D61231	33,7x2	10
D61235	42,4x2	10
D61237	48,3x2	10
D61232	33,7x2	12
D61236	42,4x2	12
D61238	48,3x2	12

Code	Ø
D61261	33,7x2
D61265	42,4x2
D61267	48,3x2

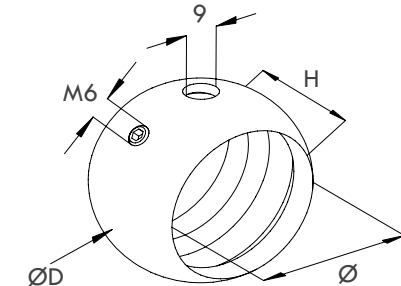
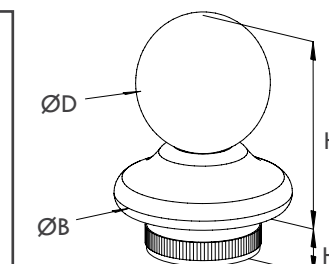

Code	Ø	H	h	ØD	ØB
D61071	33,7x2	57	15	40	49,5
D61072	33,7x2,6	57	15	40	49,5
D61075	42,4x2	62	15	45	59,5
D61076	42,4x2,6	62	15	45	59,5
D61077	48,3x2	67	15	50	59,5
D61078	48,3x2,6	67	15	50	59,5

Code	Ø	D	H
D61102	33,7	45	30
D61106	42,4	55	35
D61108	48,3	66	35

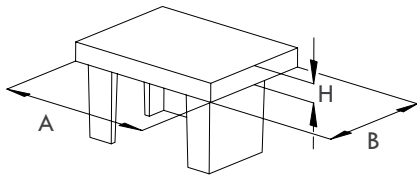
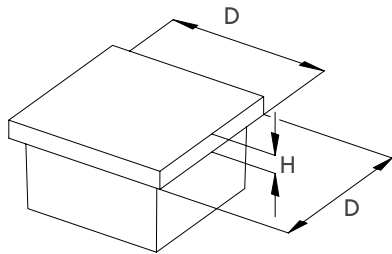

Code	D	H
D61430	12x12x2	3
D61431	20x20x2	5
D61432	25x25x2	5
D61433	30x30x2	5
D61434	40x40x2	5
D61435	50x50x2	5
D61436	60x60x2	5

Code	A x B x S	H
D61442	30x20x2	5
D61443	40x20x2	5
D61444	40x30x2	5
D61445	50x30x2	5
D61446	60x40x2	5

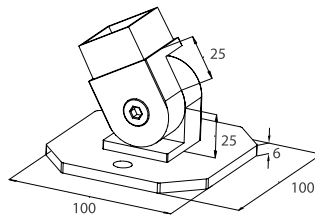
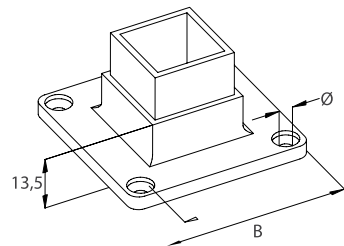
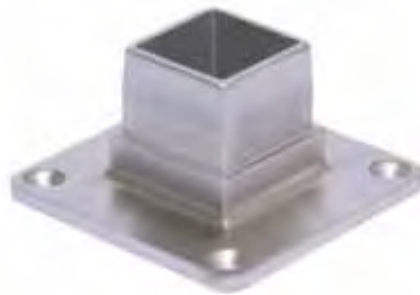

Code	Ø	Ø	B
62672-V4A	30x30x2,0	6,1	70
62673-V4A	40x40x2,0	6,1	80
62674-V4A	50x50x2,0	8,8	95
62675-V4A	60x60x2,0	8,8	105

Code	Ø
62676-V4A	40x40x2,0

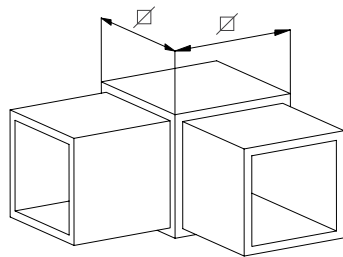
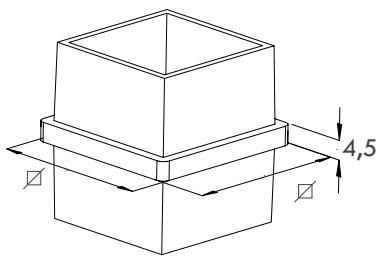

Code	Ø
D62671	40x40x2,0

Code	Ø
D62678	20x20x2,0
D62679	25x25x2,0
D62680	30x30x2,0
D62681	40x40x2,0

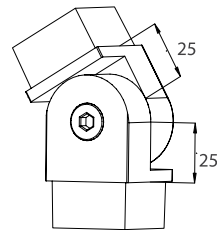

Code	
62682-V4A	40x40x2,0

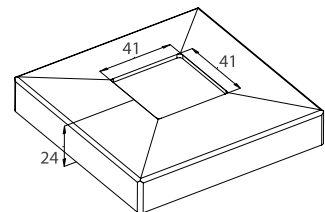

Code	
62670-V4A	108x108x1,3

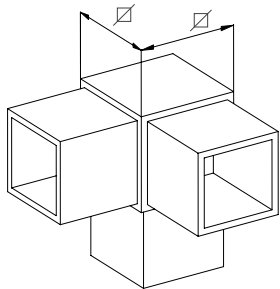

Code	Ø
D62684	20x20x2,0
D62685	25x25x2,0
D62686	30x30x2,0
D62687	40x40x2,0

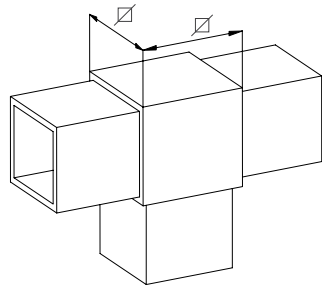

Code	Ø
D62690	20x20x2,0
D62691	25x25x2,0
D62692	30x30x2,0
D62693	40x40x2,0

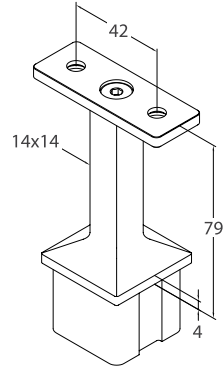

Code	
62695-V4A	40x40x2,0

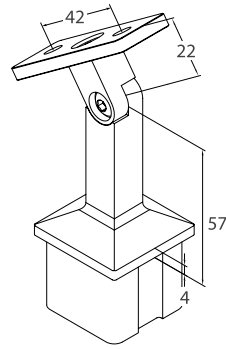

Code	
62696-V4A	40x40x2,0

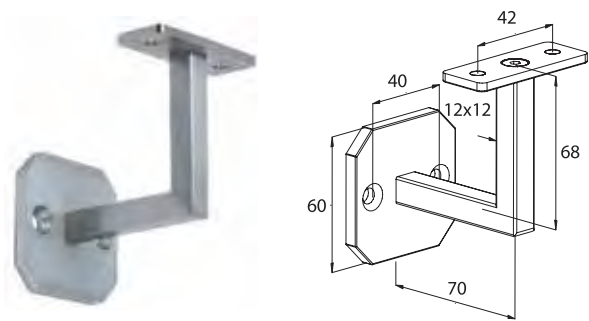

Code
66002

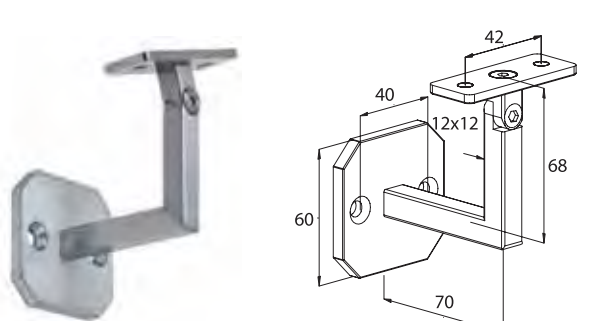

Code
66004



Code
66002

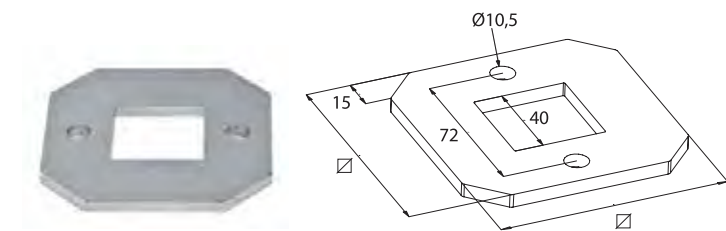

Code	Ø
65294	100x100x6

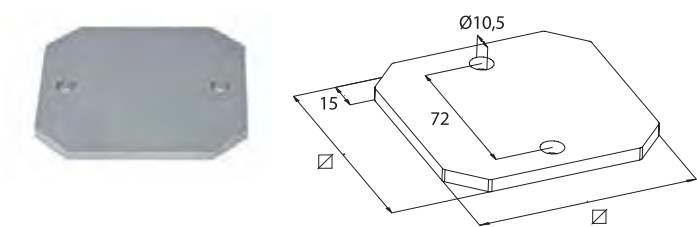

Code	Ø
65291	100x100x6

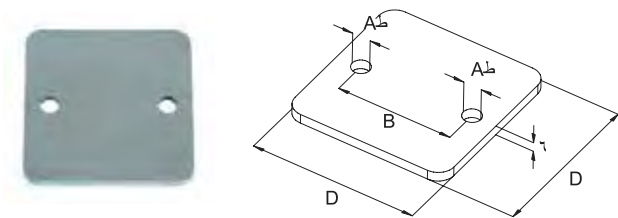

Code	ØA	D	B
65280	9	80	55
65290	11	100	70
65292	11	120	90

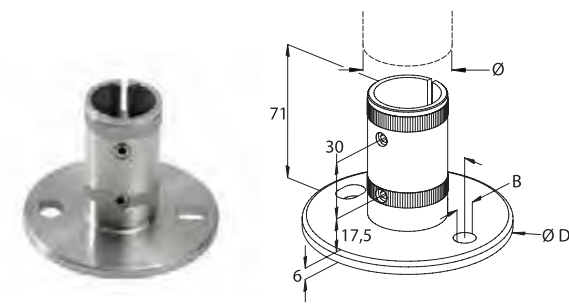

ART.	Ø	ØD	B
62501	33,7x2	80	9
62502	33,7x2,6	80	11
62505	42,7x2	100	11
62506	42,4x2,6	100	11
62507	48,3x2	100	11
62508	48,3x2,6	100	11



ART.	Ø	H	ØA
62501	105	25	25,5
62522	85	14	33,7
62526	105	25	42,4
62527	105	16	42,4
62528	105	25	48,3
62529	105	16	48,3

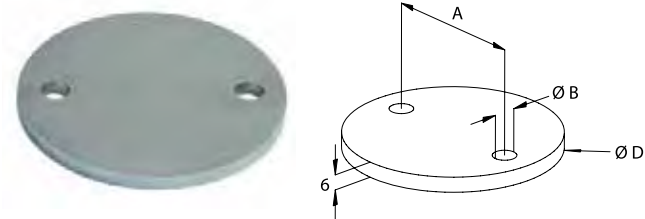

ART.	ØD	A	ØB
62533	80	56	8,5
62535	100	72	10,5

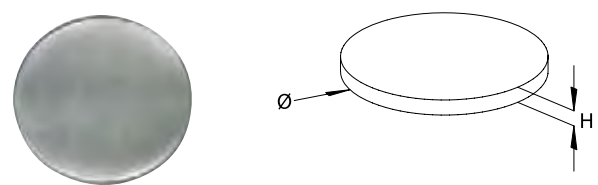

ART.	Ø	H
64233	33	4
64235	35	4
64240	40	4
64242	42	4
64245	45	4
64248	48	4
64250	50	4
64252	52	4
64260	60	4
64269	70	4
64270	70	6
64279	80	4
64280	80	6
64290	100	6
64292	120	6
64294	140	6

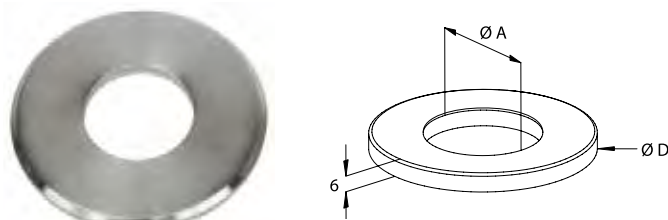

ART.	ØA	ØD
62552	34	80
62553	43	80
62556	43	100
62558	49	100



**Metal Glass
Staircase**

Metal Glass Staircase



Basic



Basic Rope



Basic Glass



Basic in Axis

Metal Glass Staircase



Twin



Twin



Twin Rope



Twin Plus



Twin Plus



Twin Plus Rope



Inox Step System



Inox Step System



Inox Step System Square



Inox Step System Rope



Inox Step System Glass



Metal Glass Staircase



Quadro



Quadro



Quadro Rope



Quadro Glass

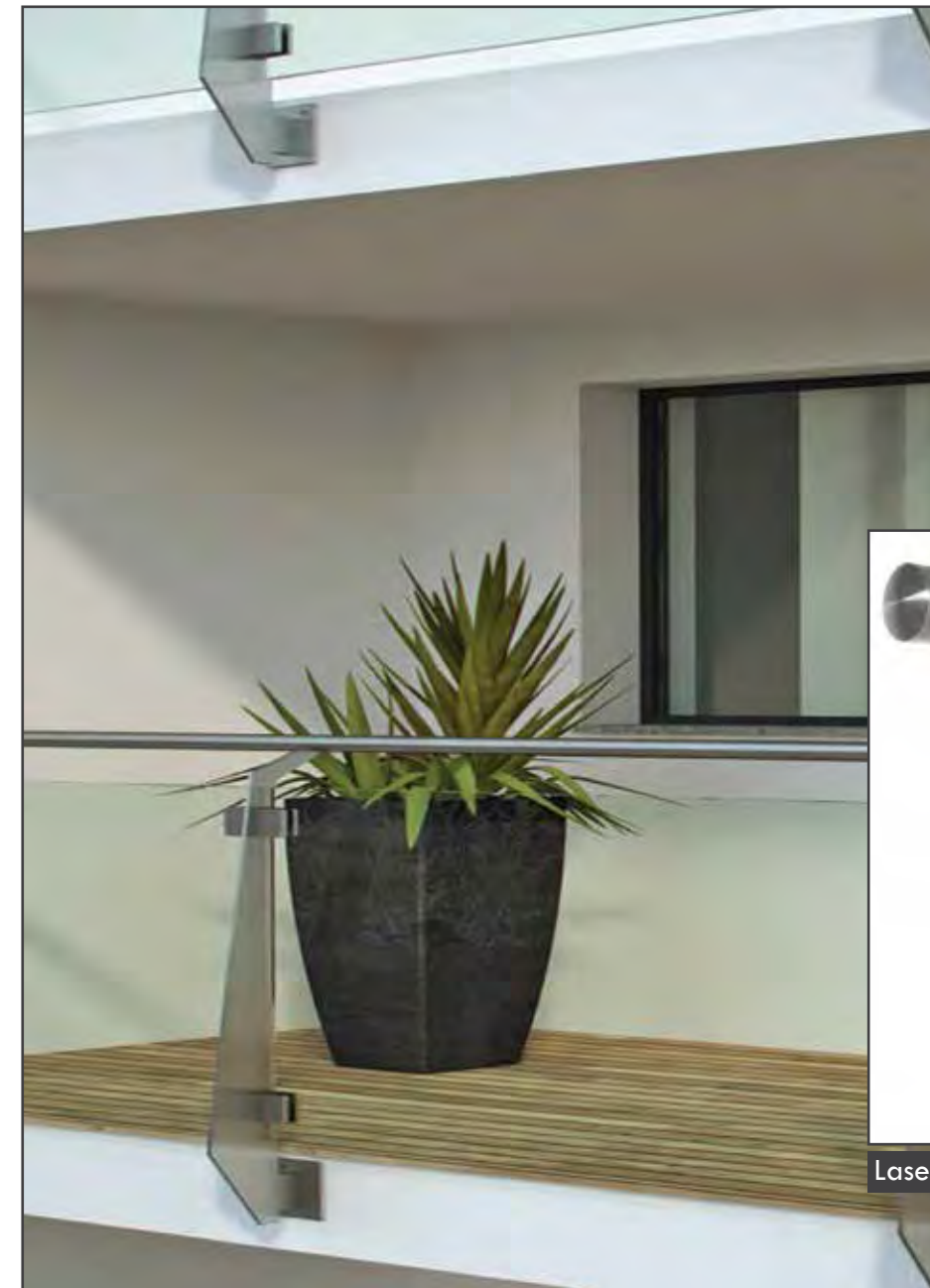

Laser



Laser



Laser Glass



Signage is all too often overlooked but critical to the success of any project.

From floor plans Delta Metallic can specify a requirement taking into consideration the needs of those who are unfamiliar with a facility and its surroundings.

Delta Metallic have, with INTERSIGN compiled suitable ranges to assist in the wayfinding methodology of any building when used by those for the first time.

Access for All should almost certainly start with signage.

Each of our companies works closely with architects, specifiers and contractors offering a full specification, scheduling, estimating, contracts management and delivery service.

Corporate Social Responsibility

Delta Metallic recognises the importance of conducting its business in a socially responsible manner. This is demonstrated in the way we deal with our employees, customers, suppliers and the communities in which we do business. We consider that corporate social responsibility is an integral element of good business management.

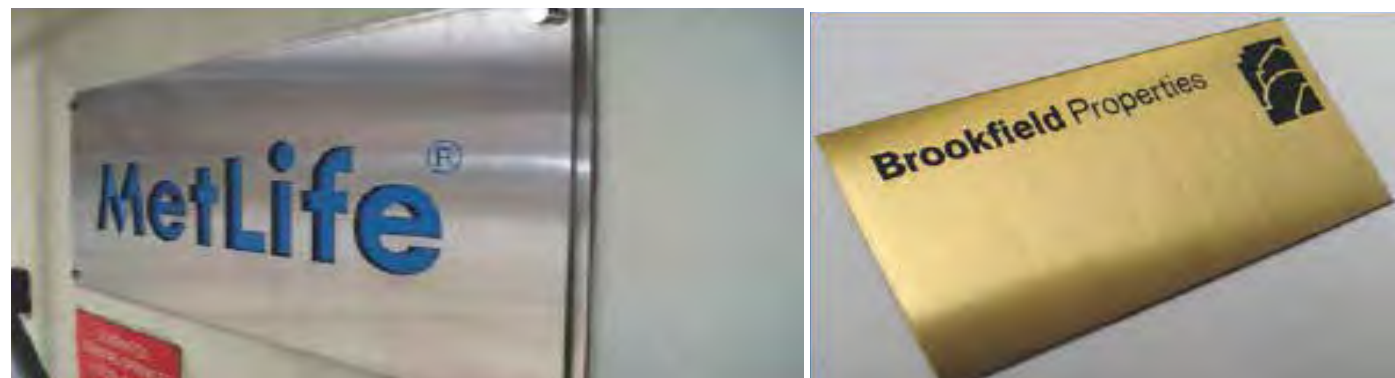

INTERSIGN can offer a wide range of sign solutions, set out below is an example of common types.

For more information on a bespoke sign package please contact us.

Pictogram 76 mm dia drilled and countersunk or self adhesive fixed.

- IS 101** Male.
- IS 102** Female.
- IS 103** Unisex.
- IS 104** Accessible.
- IS 105** Baby change.
- IS 106** Shower.
- IS 107** Telephone.
- IS 101a** Pictograms also

IS108 available 150 x 100mm.



Tactile and Braille signage.

All our tactile and Braille signs are manufactured with the guidance of the Royal National Institute for the Blind to ensure they conform to the recommendations of the Equality Act.2010

We supply Grade 1 Braille for short word signs or Grade 2 Braille) which is a contracted form (for longer sentence signs. The system we use enables us to supply tactile and Braille signs in any metal finish, such as aluminium, stainless steel or polished brass, as well as any colour plastic. This proves beneficial when there is a need to match existing door furniture.

IS109 Architectural signs and nameplates.

INTERSIGN can provide a range of standard and bespoke signs to complement all of our suites of door ironmongery in a wide range of colour and metal finishes. This signage is also available in Braille and tactile formats.

Please contact us for exact size

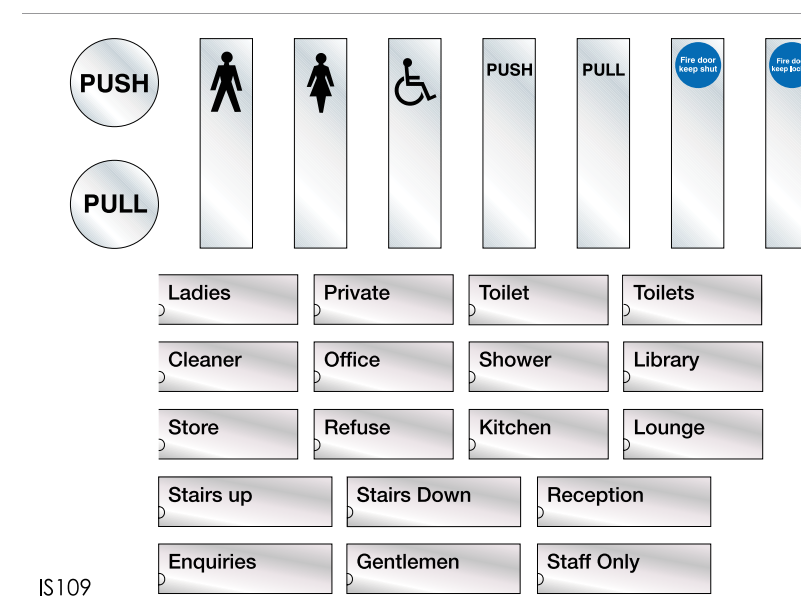

IS109



CADIC interchangeable signs.
5mm thick, silicon acrylic signs with
face plates to match any door ironmongery.

Supplied with stand-off sign supports,
silicon acrylic has a light green tint around
the polished edges to give a glass appearance.
If a door number or name requires changing,
only the face plate has to be replaced.

Standard Sizes

Numbers and Name Plates

- CAD01 86mm x 56mm
- CAD02 166mm x 56mm
- CAD03 246mm x 56mm
- CAD04 326mm x 56mm

Directories

- CAD05 426mm x 116mm
- CAD06 426mm x 166mm

Standard Finishes

Back Plates
5mm silicon acrylic

Face Plates

- SSS: satin stainless steel
- SAA: satin anodised aluminium
- PB: polished brass
- PAA: polished anodised aluminium
- HIPS: coloured plastic
- PSS: polished stainless steel

Options

- Vinyl-cut lettering
- Screen printed
- Engraved
- Tactile
- Tactile and Braille

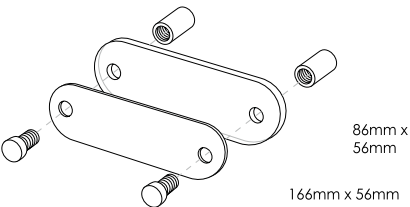

Number and Name Plates
25mm lettering

Directories
35mm lettering



90mm dia signs

- CAD07 Male
- CAD08 Female
- CAD09 Accessible
- CAD10 Unisex
- CAD11 Baby change
- CAD12 Push
- CAD13 Pull
- CAD14 Fire Door Keep Locked
- CAD15 Fire Door Keep Shut



90mm x 150mm signs

- CAD16 Male
- CAD17 Female
- CAD18 Accessible
- CAD19 Unisex
- CAD20 Baby change



Custom finish and sizes available on request.



- A 'Male' symbol on plate
- 450 x 100 mm
- Black silk screened symbol
- Drilled and countersunk
- Fixing screws included
- Aluminium or stainless steel

Finish	Cat. No.
Polished anodised aluminium	987.18.659
Satin stainless steel	987.18.650
Polished stainless steel	987.18.651



- D 'Push' on push plate
- 450 x 100 mm
- Black silk screened text
- Drilled and countersunk
- Fixing screws included
- Aluminium or stainless steel

Finish	Cat. No.
Polished anodised aluminium	987.18.659
Satin stainless steel	987.18.650
Polished stainless steel	987.18.651



- B 'Female' symbol on plate
- 450 x 100 mm
- Black silk screened symbol
- Drilled and countersunk
- Fixing screws included
- Aluminium or stainless steel

Finish	Cat. No.
Polished anodised aluminium	987.18.669
Satin stainless steel	987.18.660
Polished stainless steel	987.18.661



- E 'Fire door keep shut' on push plate
- 450 x 100 mm
- Blue silk screened symbol
- Drilled and countersunk
- Fixing screws included
- Aluminium or stainless steel

Finish	Cat. No.
Polished anodised aluminium	987.18.382
Satin stainless steel	987.18.380
Polished stainless steel	987.18.381



- C 'Disabled' symbol on plate
- 450 x 100 mm
- Black silk screened symbol
- Drilled and countersunk
- Fixing screws included
- Aluminium or stainless steel

Finish	Cat. No.
Polished anodised aluminium	987.18.679
Satin stainless steel	987.18.670
Polished stainless steel	987.18.671

Icons are graphic images used to convey a message. The benefits of using icons are that they are easy to understand, are cross-cultural, and are not limited by language.

General icons include a number of universal images such as the No Smoking, Handicapped and Restroom symbols. Icons, as the name implies, are generic and can be used in any location.

Men's Restroom				
Women's Restroom				
Unisex Restroom				
Handicap Access				
Information				
Telephone				
Cafeteria				
Gift Shop				
Service Elevator				
Elevator				
No Smoking				
In Case of Fire Use Stairs				
Do Not Enter				
Exit				
Radioactive				
Alarm				
Security				
Text Telephone				
Volume Control				
Telephone Administration				

Metals and Stainless Steel Signage finishes

STAINLESS STEEL / ALUMINUM / BRASS / COPPER / TITANIUM / LED ILLUMINATION / FABRICATION / WATERJET

STAINLESS STEEL



Polished Stainless Steel



Satin Stainless Steel



Painted Stainless Steel



Non-Directional Stainless Steel

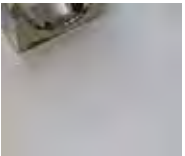

Bead Blasted Stainless Steel

TITANIUM



Polished Gold Titanium



Satin Gold Titanium



Light Satin Bronze Titanium



Light Polished Bronze Titanium

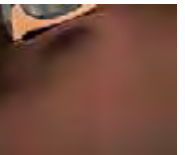

Dark Satin Bronze Titanium



Dark Polished Bronze Titanium

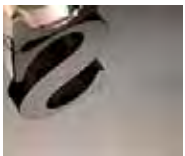

Polished Black Titanium



Satin Black Titanium

Brass



Polished Brass

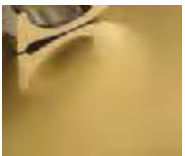

Satin Brass



Non-Directional Brass



Bead Blasted Brass



US10B Oxidized Brass

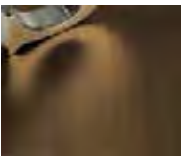

Dark Oxidized Brass

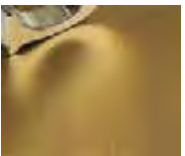

Light Oxidized Brass

Copper



Polished Copper

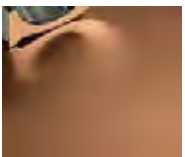

Satin Copper



Non-Directional Copper

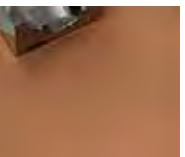

Bead Blasted Copper



Hammered Copper



Patina Blue Copper



Verdigris Green Copper

Q3C1E Signage guide D100S

Example:



Technique:
- Door signage made of stainless steel with printed or Etched on information signs and additional mounting plate on the back

Function:
- Display of the symbol
- for Studs mounting onto walls or doors to be fixed at panel back or using double side glue tabe

Material:
- Plate made of stainless steel ,Mirror,satin ,,150 x 150 mm, 0.8-1.5 mm thick
- symbol is printed on or Acid Etched
- Substructure made of stainless steel or any required metal.

brushed:
- Paint: Animal Matt Paint. (Black , Blue, ...)
- signage plate size: 100x100mm, up to any spacific Size.
- Signage Plate corner edge to be 90 degree or round with R2 to 10mm.



Dimensions in mm

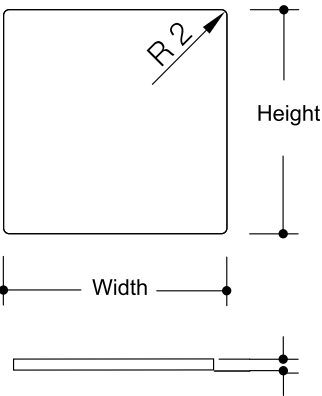

Product is eliminated from 31.12.2012

Surface
Metallic selected finish
mirror, brush, other..

Alternative surface/colour
selected for color chart



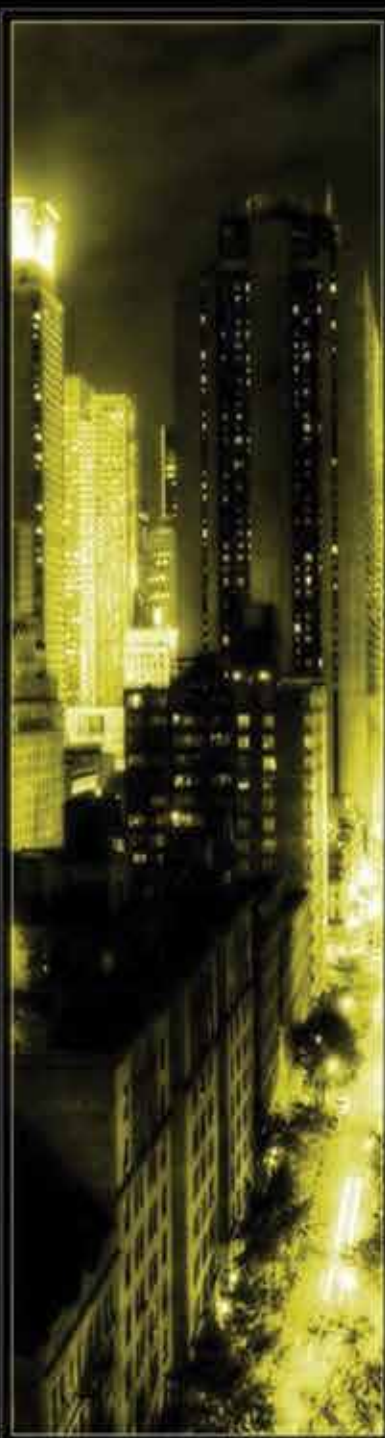
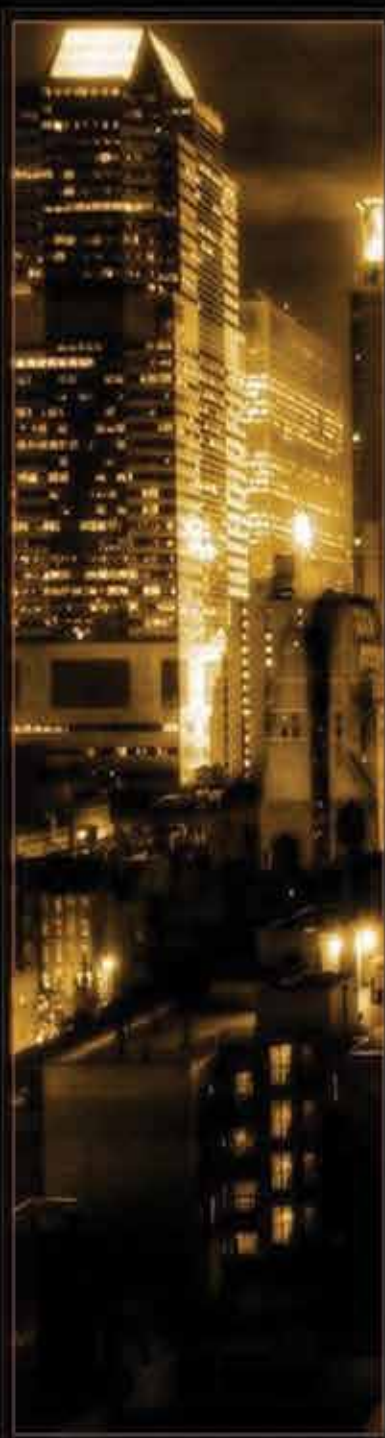

Projects

DUBAI TV PROJECT



DUBAI AIRPORT SS LATTICE PROJECT



APM STATION DUBAI AIRPORT C3 PROJECT



DUBAI FESTIVAL FOUR SEASON CLUB PROJECT



DUBAI AIRPORT LAST STAGE PROJECT

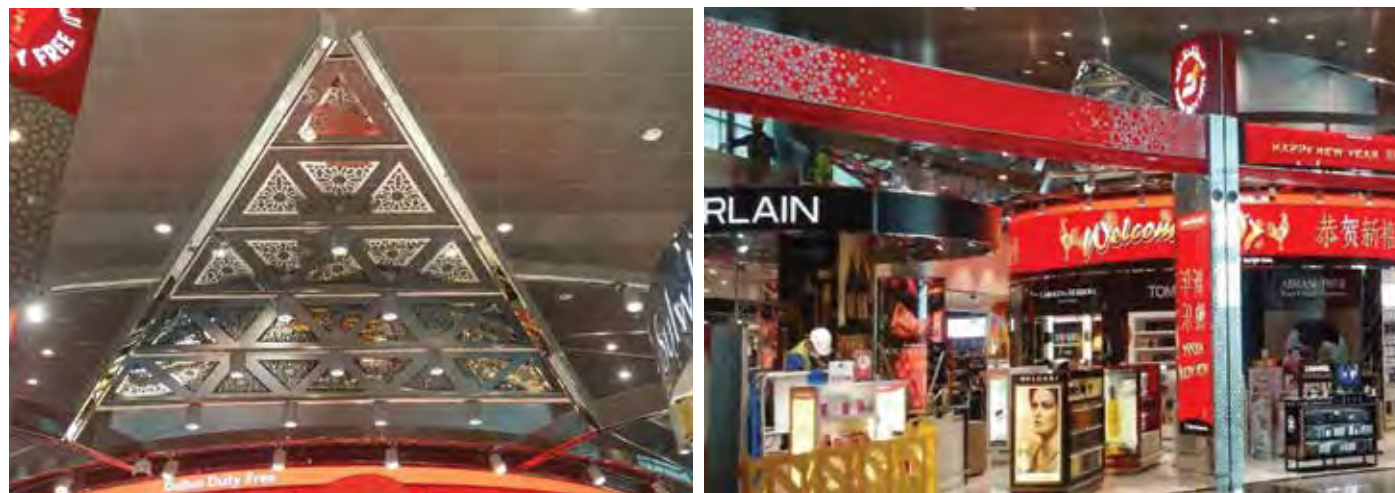

DUBAI MARINA MALL FLOOR RISES PROJECT



SHARJAH EXPO EXHIBITION PROJECT

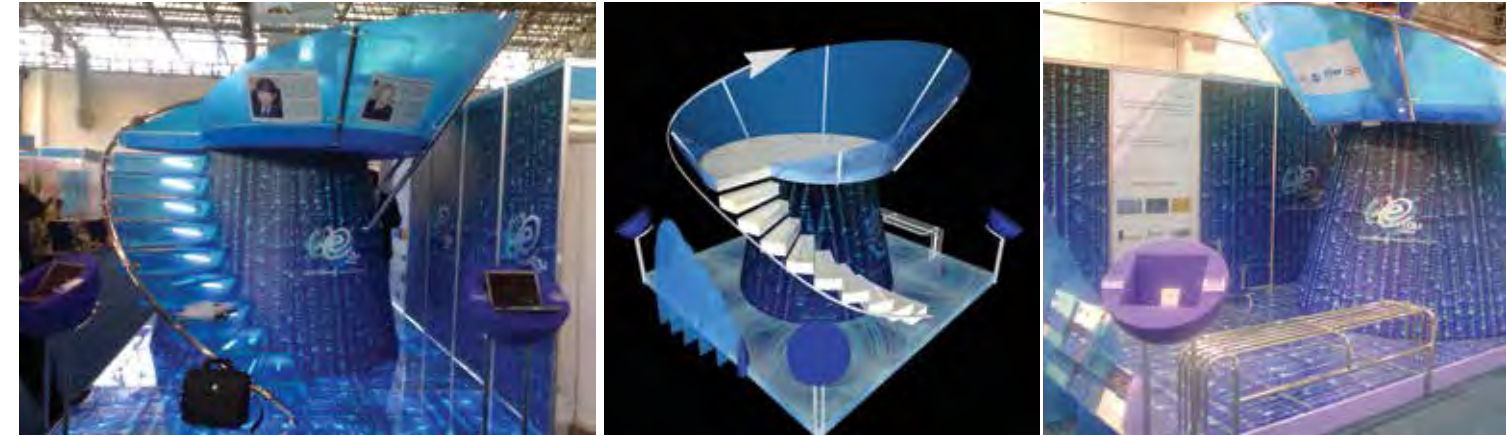

DUBAI METRO PROJECT PROJECT



STAINLESS SLIGING DOORS FOR PRIVATE VILLA IN ABU DHABI PROJECT

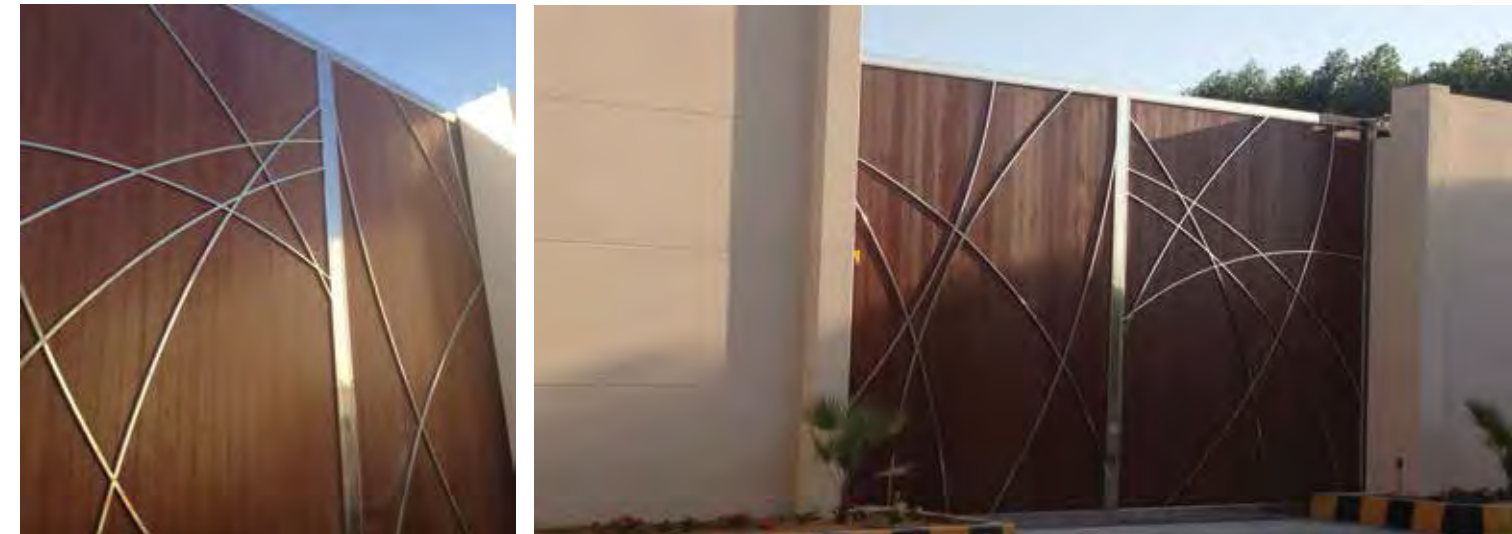

Certificate of Registration

This is to certify that compliance of Environmental Management System of

DELTA METALLIC CONST. FACTORY LLC

P. O. Box No: 23632, Sharjah, U.A.E.

Has been assessed and found to conform the requirements of

ISO 14001 : 2004

for the scope of activities :

Steel Construction, Fabrication, Installation of Architectural Metals and Glass Fit Out Works

Certificate No. : RE97/JA/IC/1463 Issue Date : 27.06.2016
JAS-ANZ Accreditation No : M44303101C Certificate Valid Upto : 26.06.2019



Regional Office U.A.E

For and on behalf of Quest Certification (P) Ltd
Head of Certification

The Validity of this Certificate can be verified from www.questcertification.com
The Registration does not assure the quality of yields under the firm's production / services

Quest Certification (P) Ltd

Accredited by Joint Accreditation System of Australia and New Zealand (www.jas-anz.org/register)

Certificate of Registration

This is to certify that compliance of Quality Management System of

DELTA METALLIC CONST. FACTORY LLC

P. O. Box No: 23632, Sharjah, U.A.E.

Has been assessed and found to conform to the requirements of

ISO 9001 : 2008

for the scope of activities :

Steel Construction, Fabrication, Installation of Architectural Metals and Glass Fit Out Works

Permissible Exclusions: 7.3 Design and Development

Certificate No. : RQ97/JA/1463 Issue Date : 27.06.2016
JAS-ANZ Accreditation No : M44303101C Certificate Valid Upto : 26.06.2019



www.jas-anz.org/register

Regional Office U.A.E

For and on behalf of Quest Certification (P) Ltd
Head of Certification

The Validity of this Certificate can be verified from www.questcertification.com

The Registration does not assure the quality of yields under the firm's production / services

Quest Certification (P) Ltd

Accredited by Joint Accreditation System of Australia and New Zealand (www.jas-anz.org/register)

AMS JOINERY

على موسى وآلهم للصناعات الخشبية
AL MOOSA & SONS JOINERY INDUSTRIES

Ref No.: AMSJ/AL-001/Join.indh.033
Date: March 12, 2013

Mr. Mutaseem Ghannam
Delta Metallic Construction Factory
P.O. Box: 23632
Sharjah, U.A.E.

Subject: Letter of Appreciation

Dear Sir,

AMS Joinery & Furniture Industries wishes to extend our deepest gratitude and appreciation for the dedicated efforts, the hard work and the outstanding quality of service provided by your team in providing us your most excellent execution for the Projects done.

We further comment that due to your continuous support and efforts we were able to match the delivery schedules without any failure.

As we move forward, your excellent performance will not be forgotten and you can be sure that we will continue to look for ways to continue our relation with DELTA Metallic for our future Projects.

Name of the Projects:

- ADNOC Filling Station
- AL Jaber Optics
- Fineline
- Private Villa's

Thanking you.

For Al Moosa & Sons Joinery Industries

12/3/13
Engr. Amr A. Al Obaidy
General Manager
AMS Joinery & Furniture Industries

Head Office: P.O. Box: 22484, Sharjah, U.A.E. Tel.: +971-6-5311444 / 5311533, Fax: +971-6-5311033
e-mail: Joinery@amsj.ae, website: www.amsj.ae

SUBCONTRACTOR APPROVAL REQUEST SCA Contract No.: SP070 CONCOURSE - C & B AND TERMINAL I (BHS HALLS C & D) IMPROVEMENT WORKS		06 SEP 2016 RETAIL CONCEPTS DESIGN
		SUBMIT VOUCHER REQUEST
DUBAI INTERNATIONAL AIRPORT EXPANSION PROJECT Reference No.: SCA No.: 065 (Rev. 0) Contract Title: SP070 CONCOURSE - C & B AND TERMINAL I (BHS HALLS C & D) IMPROVEMENT WORKS To: DAI AL HANDASAH SHAK & PARTNER From: AL SHAKIR GENERAL CONTRACTING LLC		DUBAI AVIATION PROGRAMME PROJECTS
Project Name: DUBAI INTERNATIONAL AIRPORT EXPANSION PROJECT SCA No.: 065 (Rev. 0) Contract Title: SP070 CONCOURSE - C & B AND TERMINAL I (BHS HALLS C & D) IMPROVEMENT WORKS To: DAI AL HANDASAH SHAK & PARTNER From: AL SHAKIR GENERAL CONTRACTING LLC		Date: 03.09.2016
A - WORK TO BE SUBCONTRACTED Approval Request For: PRE-QUALIFICATION - DELTA RETAILLIC CONSTRUCTION FACTORY LLC Description of Work to be Subcontracted: RETAILTIC WORKS FABRICATION AND INSTALLATION		
Dear Sir, Please find enclosed herewith supporting documents pertaining to the proposed Subcontractor (SCS) includes the following:		
1. Name and classification. 2. Details of recent performance. 3. Type, number and current location of plants to be deployed on this project. 4. Full list of names, qualifications and experience of staff. 5. Outline method statements of performance. 6. Written confirmation that he will Act and Comply in full conformity with the Contract and all its conditions and specifications. 7. Confirmation / Invoiced from relevant Authorities		
Contractor's Authorized Signature: _____		
ENGINEER'S COMMENTS (TECHNICAL) (An approved design must relieve the Contractor of his obligations under the Contract and he shall be liable for all a/c, defects and negligence by the Subcontractor). * APPLICABLE FOR DDRE AREAS ONLY * * Refer to attached Engineer's Comments.		
Signed By: _____ Engineering Manager _____ Date: _____		
ENGINEER'S COMMENTS (CONSTRUCTION) NO DISCREPANCY FOR RETAIL WORK WITHIN DAI AREAS THE CERTIFICATE OF APPROVAL IS ISSUED IN C & B Signed By: _____ Architect Engineer _____ Date: 14/09/16		
DOCUMENT STATUS <input checked="" type="checkbox"/> Code 1 - Work may proceed. <input checked="" type="checkbox"/> Code 2 - Review & resubmit. Work may proceed, subject to incorporation of comments indicated. <input type="checkbox"/> Code 3 - Review & resubmit. Work may not proceed. <input type="checkbox"/> Code 4 - For information.		
Deputy Chief Resident Engineer _____ Chief Resident Engineer _____ Date: 17/10/2016		
AL SHAKIR GENERAL CONTRACTING LLC RECEIVED Date: 18/10/2016 9:40PM 		
(ASGC Form-CO-0100-04)		



DELTA METALLIC

CONSTRUCTION FACTORY L.L.C.
مصنع دلتا للمعادن الإنشائية

Certificate of Completion

Ref No: 55/DMCF/2015
Date: 24/11/15

M/s. The FITOUT LLC
Dubai United Arab Emirates

Subject: Completion Certificate

Project: LPO# F30151- Supply, Fabrication & Installation of Metal Works with Bronze Plated cladding inclusive of handles and shirting as per attached Annexure

Project Location: Al Bahar Tower Sheikh Mohammed Bin Zaid Office.

Dear Sir,

We would like to inform you that we already complete the work as per Project Reference, mention above and we need your kind signature & stamp to certify.



Photo of Completed Project

Yours Faithfully,

For DELTA METALLIC CONST. FACTORY LLC



Engr. Loay Ghannam
General Manager
055-4155049



The FITOUT LLC

Received by: _____

Signature: _____

Stamp: _____



Tel: +971 8 2284421 فاكس: +971 8 2284421

Fax: +971 8 5388204 هاتف: +971 8 2284421

P.O. Box: 22827, Sheikh J.B. Road, DUBAI البريد الإلكتروني: info@deltaconstruction.ae

E-mail: info@deltaconstruction.ae الموقع الإلكتروني: www.deltaconstruction.ae

Industrial Area no. 8, Sharjah, U.A.E. الهاتف الخليوي: 055-4155049

www.deltaconstruction.ae



Al Jaber L.E.C.T. Engineering & Contracting (ALEC) L.L.C.
 الجابر إل اى جى تى انجنيئرنگ و القاولات (الايك) - ل.م.م

AMU DUBAI
 Villa 1, Main Road, Ras Al Khaima
 PO Box 45386 Abu Dhabi UAE
 Tel: +971 2-558 7540
 Fax: +971 2-558 5444

CS&A/
 3001 Marina Plaza
 Dubai Marina
 PO Box 27639 Dubai UAE
 Tel: +971 4-428 0280
 Fax: +971 4-428 0285
 Email: info@csa.ae
 www.sbs.ae

أبو ظبي
 فيلا رقم ١ - شارع رئيسي
 ص.ب ٤٥٣٨٦
 أبو ظبي
 ص.ب ٤٥٣٨٦
 الإمارات العربية المتحدة
 الهاتف: +٩٧١ ٢ ٥٥٨ ٧٥٤٠
 الفاكس: +٩٧١ ٢ ٥٥٨ ٥٤٤٤

دبي
 ٣٠٠١ مارينا بلازا
 دبي مارينا
 ص.ب ٢٧٦٣٩
 الإمارات العربية المتحدة
 الهاتف: +٩٧١ ٤ ٤٢٨ ٠٢٨٠
 الفاكس: +٩٧١ ٤ ٤٢٨ ٠٢٨٥

10th April 2014

TO WHOM IT MAY CONCERN

RE: DELTA METALIC CONST. FACTORY LLC

This serves to confirm that Ms. Delta Metallic Const. Factory LLC has been engaged in Dubai International Airport Expansion (Phase II) project since June 2012 to December 2012 as the Domestic Subcontractor for Structural Steel works in the value of AED 2,408,153.00 (Two Million Four Hundred Eight Thousand One Hundred Fifty Three UAE Dirhams Only).

Followings are the summary of works completed by Delta,

- Supply and installation of lattice ceiling work in Dubai Duty Free
- Supply and installation of digital media frame work in Dubai Duty Free
- Supply and installation of steel light tracks in Dubai Duty Free
- Supply and installation of steel trench cover in APM station
- Dismantling of handrails in APM station

While performing above works Delta proven to be a reliable, diligent Contractor, who has handled his responsibility well, and puts the necessary effort into the timeous completion of the works awarded to them.

Sincerely,

For: Al Jaber L.E.C.T. Engineering & Contracting (ALEC) L.L.C.

Brett Williams
 Commercial Manager
 Dubai International Airport (Concourse 3) Project

SCA	
Project Name:	Dubai International Airport
Reference No.:	SCA No.
Contract No.:	AE08-2008
TO: DARABP/ALCT/CONC3	
A - WORK TO BE SUBCONTRACTED	
Agreement Request For DELTA 302	
Description of Work to be Subcontracted	
Order No.:	
Please find enclosed herewith copy	

	DUBAI AVIATION ENGINEERING PROJECTS CORPORATION		
SCA	SUBCONTRACTOR APPROVAL REQUEST	Contract No.: AX174	
Project Name: Global International Engineering, Contractors & Phase V			
Reference No.: SCA No. : 12000/SCA/2014/01		Date: 07/05/2014	
Contract Title: AX104 - FURNISH, MEP, K&E, URS&E FOR CONCRETE 1			
TO: DARABASH (ALTAHAFIP)		FROM: ALEC	
A - WORK TO BE SUB-CONTRACTED Approved Project for DELTA METALLIC COINTE FACTORY LLC Description of Work to be Subcontracted: Steel Corridor with SS cladding.			
One to,			
Please find enclosed herewith supporting documents pertaining to the proposed Subcontractor which includes the following:			
1. Name and introduction 2. Details of recent performances 3. Type, number and current location of places to be employed on this project 4. Full list of records, qualifications and experience of staff 5. Outline verified statement of performance 6. Written confirmation that he will Act and Comply in full conformity with the General and the rules. Contractor's confirmation programme 7. Certificate / licenses from relevant Authorities			
Contractor's Actual/indirect Signature: 		Date: 20-10-12	
ENGINEER'S COMMENTS (TECHNICAL): (We approved does not release the Contractor of the obligations under the Contract and he shall be liable for all acts, omissions and negligence by the Subcontractor.) CONTRACTOR TO PROVIDE A MONTH SETTLEMENT			
Signed By:		Engineering Manager Date	
ENGINEER'S COMMENTS (CONSTRUCTION): TO BE CHECKED AFTER SETTING-			
Signed By:		Assistant Engineer Date	
DOCUMENT STATUS <input type="checkbox"/> Grade 1 - Work only processed. <input type="checkbox"/> Grade 2 - Revised & resubmitted. Work may not proceed. <input type="checkbox"/> Grade 4 - For Information.			
Study Civil Resident Engineer		Chief Executive Engineer Date	

HQ Quarter
Office Furniture and Interiors
(Turn-Key Project Solutions)

Date: May 28, 2012

TO: DELTA METALLIC CONST. FACTORY LLC
P.O. Box 23632, Sharjah,
United Arab Emirates

ATTN: Mr. Mutasem Mohammed
Business Devt. Executive

RE: LETTER of APPRECIATION for PROJECTS

Dear Sir:

Head Quarter Facilities Supply LLC wishes to extend its sincere gratitude and appreciation with utmost recognition of your effort and works regarding the premium quality standards provided by your company.

Your team contributes to the fullest extent and meets the schedule as agreed terms. The planning, execution and completion methods were remarkable and contributed immensely in achieving the required premium standards and outcome that left our stakeholders with satisfaction and appreciation from your team.

Wishing you all the success and certainly looking forward working with Delta Metallic on future projects.

Yours Faithfully,
Ahmad Hasan Abdelatif
Managing Director

P.O. Box: 232108, Dubai, U.A.E.
Tel.: + 971 4 2525528 Fax: + 971 4 2525529 E-mail: hqquarter@delta-metallic.com

ICL INTERIORS L.L.C. ORIGINAL

Our Ref : LCLQS/DMCF/DL2703/L00319/AHA/tea19.
Date : 20 Oct. 2009.

To Whom It May Concern,

RE: DELTA METTALIC CONST. FACTORY LLC

Here by we are confirming that Ms. Delta Metallic Const. Factory LLC has been involved and joined in **Dubai Metro project in 17 Station of Red Line** since June 2008 to December 2009 as a one of our main Subcontractor for Structural Steel works, and metal decoration items in the value of **AED 10,370,175.00**
(Ten Million Three Hundred Seventy Thousand One Hundred seventy five UAE Dirham's Only).

With following of the works summary completed by Delta Metallic Const. Factory:

- Supply and Installation of Steel structure of staircase in Stations.
- Supply and Installation of Aluminum Etched Panels for binnacles and all cladded Walls in Stations with powder coating.
- Supply and Installation of Stainless steel cladding for lifts entrance and cladding panels.
- Supply of Stainless steel Stone and mirrors frames.
- Supply and Installation of Aluminum Skirting Profile in silver anodized color.
- Supply of Stainless steel and brass Marble inserts.
- Supply and installation of Stainless steel public Telephone cabinet stand in Metro stations.
- Supply for Steel, Stainless steel and aluminum fixing brackets for General cladding purposes.
- Other General Metal works.

Delta Metallic Const. Factory LLC, has completed its work since the first to the last moment in high quality and respecting for time, we entrusted to their seriously, which had a clear role in resolving the obstacles that we faced in the project.

Delta metallic was an example of the credibility and hardworking.
LCL Interiors L.L.C. are really pride to deal with them.

Thank you.
Yours Faithfully,
LCL INTERIORS L.L.C.
ABDUL HAKIM ASMAM
REGIONAL DIRECTOR

حكومة دبي
GOVERNMENT OF DUBAI

بلدية دبي
DUBAI MUNICIPALITY

Ref: 812/02/02/1/1409131 09/07/2014

M/s. Greenland
Post Box 84804
Dubai.

Fax No.04-2637272

Dear Sirs,

PROJECT: PJ-20025 Al Twar Second Neighbourhood Park

Subject: Approval of Sub-contractor for Aluminium Works

Further to your letter ref. GLC/DM/PJ20025/S2628 dated 06/06/14, kindly be informed our 'No Objection' to your proposal/recommendation to employ M/s Delta Metatalic Const.Factory LLC as subcontractor for Aluminium Wroks of the captioned Project subject.

The above 'No Objection' shall in no-way invalidate any obligation of the Contractor under the contract.

This is for your kind information and appropriate action.

Yours faithfully,

ENG. FATIMA ESSA AL MUHAIRY
HEAD OF LANDSCAPE SECTION

cc: Director of Gen. Projects Dept.
Planning and Development office
SI1-0707014

رؤيتنا: بناء مدينة متميزة تتوفر فيها استدامة وإلحاحية العيش ومقومات النجاح.
Our Vision : Creating an excellent city that provides the essence of success and comfort of sustainable living.
ص.ب: 67 دبي، إ.ع.م. هاتف: +971 4 221 5555 ، فاكس: +971 4 224 6666
P.O.Box : 67 DUBAI, U.A.E, Tel.: +971 4 221 5555, Fax: +971 4 224 6666

EXPO 2020 إكسبو 2020
دبي، الإمارات العربية المتحدة
DUBAI UNITED ARAB EMIRATES



سيما لأعمال الألمنيوم ذ.م.م.

SEEMA ALUMINIUM WORKS L.L.C

18 March 2013

APPRECIATION CERTIFICATE

This is to certify that **DELTA METALLIC CONSTRUCTION FACTORY L.L.C.**,
P.O.Box: 23632, Sharjah (UAE) has executed Steel works for the construction of:

"2P +G +7 typical floor, 5 -Star Marbella Bay Hotel, RAK
For M/s. Manazil Real Estate.

During the period of construction Company has performed their duties diligently and successfully to the utmost satisfaction of the Project Management and proved to be self motivated and consistently reliable for the works assigned for.

We wish company's team members all the success in their future endeavors.

Eng. Mohamed Kamal El Haj Ali
Managing Partner
Seema Aluminium Works L.L.C.





Dubai Rapid Link Consortium
Union Square, Al Maktoum Road
corner Omar Bin Al Khattab Road
Dubai, UAE
Tel. No. +971 4 2212321
Fax No. +971 4 2212381

Transmittal Form Reference no. : Transmit/PDAT/323

To: Mr. Mutasem Ghannam	From: JTHUN
Site: Palm Jumeirah Site Office	Company: Architectural and Technical Dept.
Date: 30/3/2010	Date: 30/3/2010

Enclosed document/s (please check boxes):

☐ Letter ☐ Drawing/s ☐ Method Statement/ITP

☐ Others: (Please specify) _____

No	MATERIAL	STATUS	REMARKS
1	FRITTED GLASS ACTUAL SAMPLE		BY SIGNED SAMPLE FOR QC/QA CONTROL SAMPLE
2	ALPS METAL PANEL BROWN WAVE RELIEF	APPROVED BY KCA	NOTE: ACTUAL SAMPLE WILL BE MOVED WITH IN STOCK

Verified as to correctness of the above Document/s:

EVANGELINE R. MARCELO
Name and Signature

30/03/2010
Date

*** Location code: ***
*** Location code: ***

Received by:

Name and Signature

30/03/2010
Date



APPROVED

Material/Finish Code:
Date: 30/3/10

MATERIAL CODE: MP8
FINISH CODE: 1630
DESCRIPTION: METAL PANEL -
BROWN WAVE RELIEF
SUPPLIER: DELTA METALLIC CONST.

Form No. 220108-001 Rev. A June 06, 2009

P.O.Box: 22129, Sharjah - U.A.E. Tel 1: +971 6 543 4202 Tel 2: +971 6 543 4203
www.seema.ae seema_alum@yahoo.com



INTERIOR DESIGN &
FURNITURE MANUFACTURERS

Al Qusais Industrial 3, Dubai, United Arab Emirates
Tel: 04-2671675, Fax: 04-2671812
Email: safaride@emirates.net.ae

15 May 2013

Delta Metallic Construction
P.O. Box # 23632, Sharjah-UAE

Attention : Mr. Mutasem Ghannam

Project : **COMMERCIAL BANK INTERNATIONAL**

Subject : **LETTER OF APPRECIATION**

Dear Sir,

We take this opportunity to express our appreciation of your efforts in assisting us in what has been a challenging project to all.

In particular we note that your team has continually assisted and cooperated in solving the vast amount of technical problems that we have faced.

We further comment that your team has shown professionalism and diligence which has helped us deliver this project to the satisfaction of our Client, CBI, UAB & AL ARAB.

It has been a pleasure working with you and we look forward to working with you again on our further endeavors.

Yours faithfully,

Raed Mikail
 Projects Manager
 For and on behalf of
 Safari Décor LLC



P.O. Box : 93666 Dubai, U.A.E. Tel : +9714 2671675, Fax : +9714 2671812, E-mail : safaride@emirates.net.ae